



Thank You!

You have successfully downloaded your document from Workbenchmagazine.com. Below are some tips for Trouble-Free Printing

- 1)** Clear printer memory. If you are unable to print this document, turn off your printer for at least 15 seconds and try again.

- 2)** Print two or three pages at a time. If clearing the printer memory didn't help, try printing only two or three pages at one time, rather than sending the entire file

- 3)** If a document is required to be at an accurate scale set the page scaling option to "none" in your printer settings.

- 4)** Get advanced printer help. Visit Adobe Support for instructions in troubleshooting common printer problems.

<http://www.adobe.com/support/techdocs/316508.html>

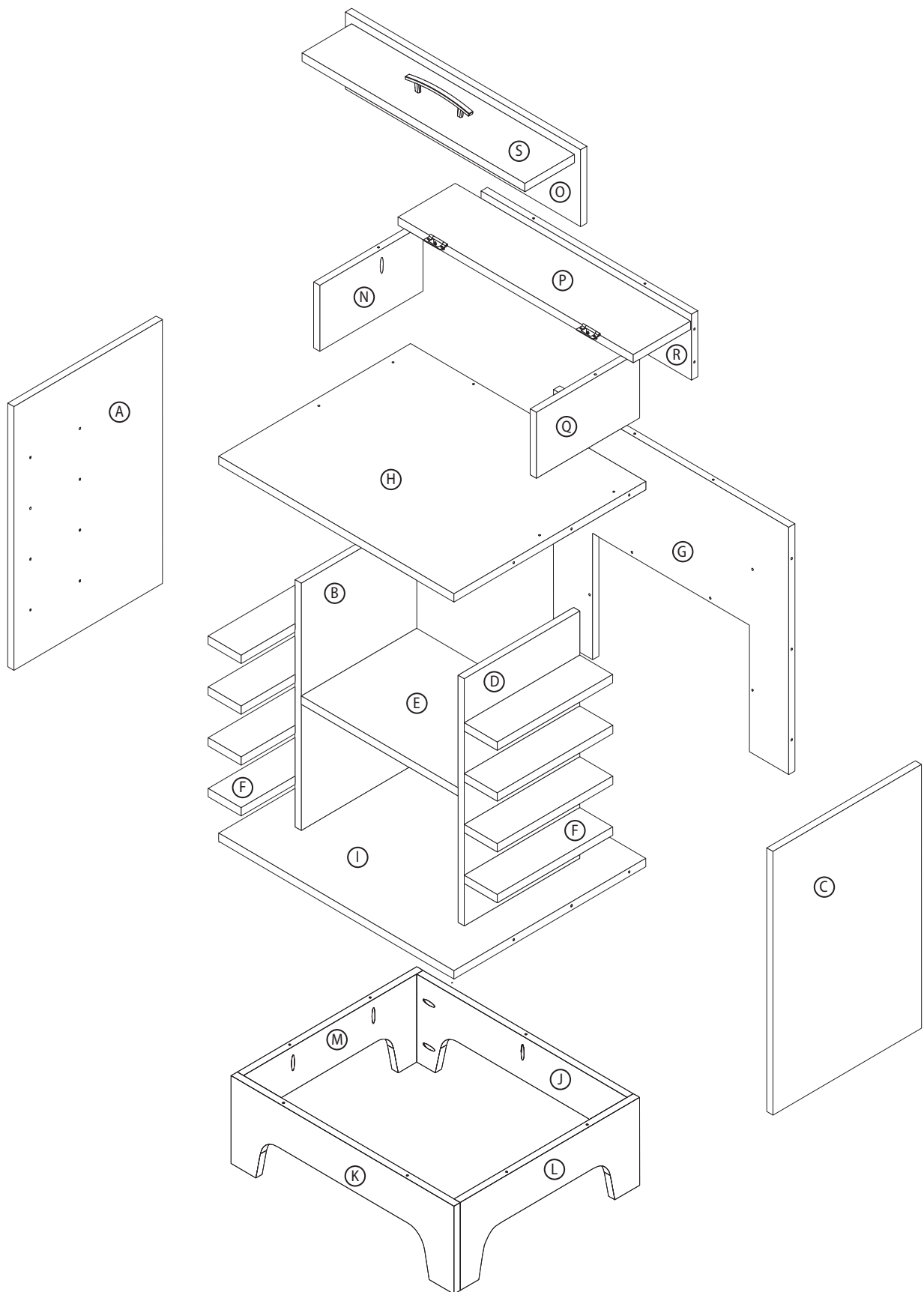

FRONT VIEW

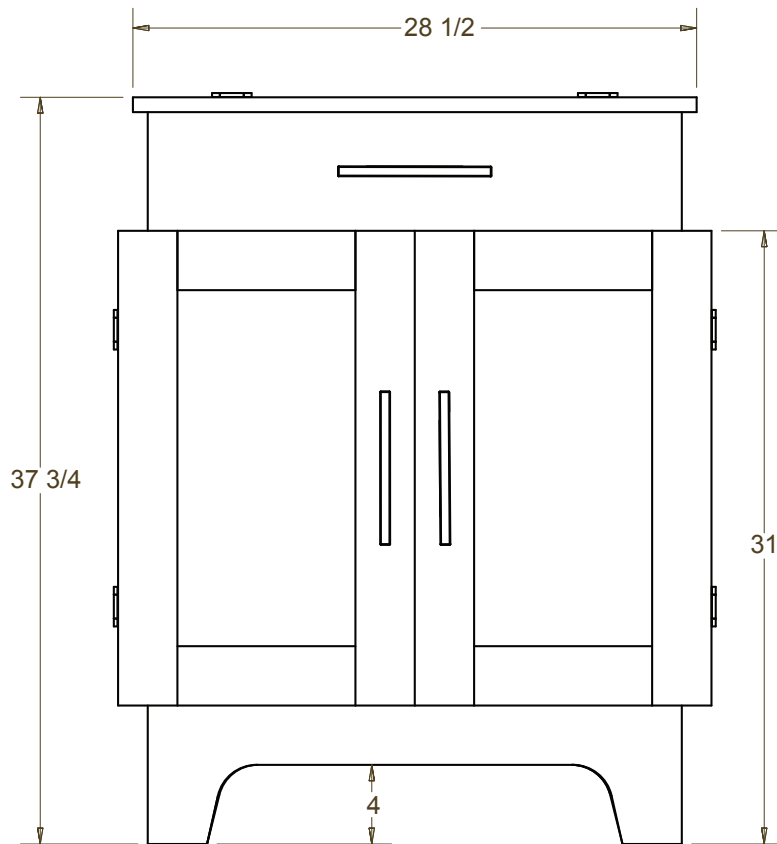

BACK VIEW

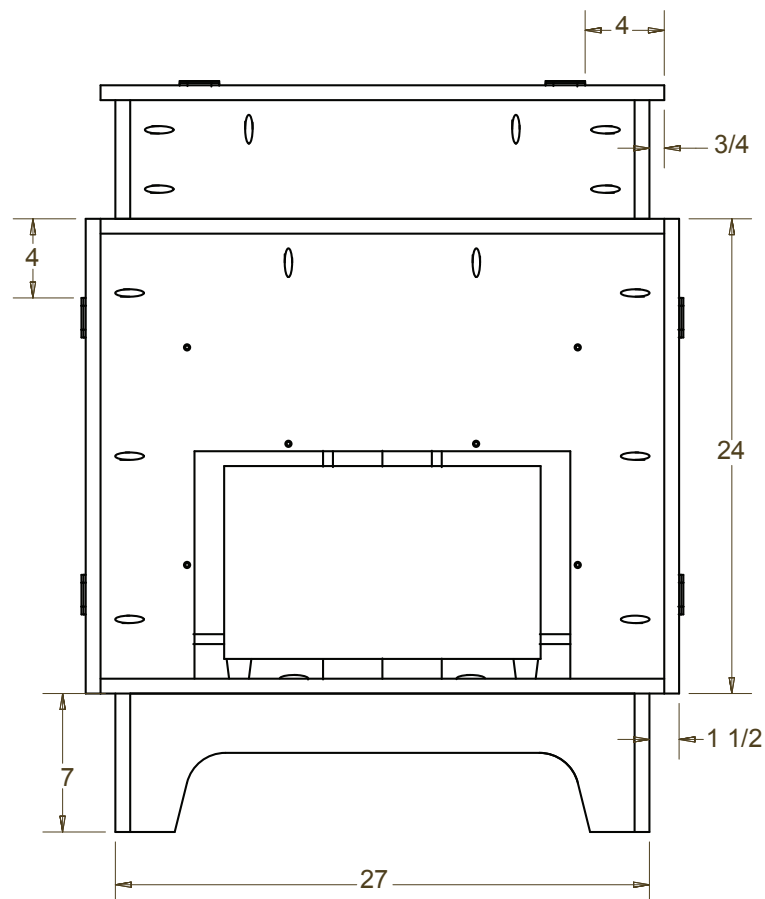

NOTE:
USE 2"
NO-MORTISE
HINGES

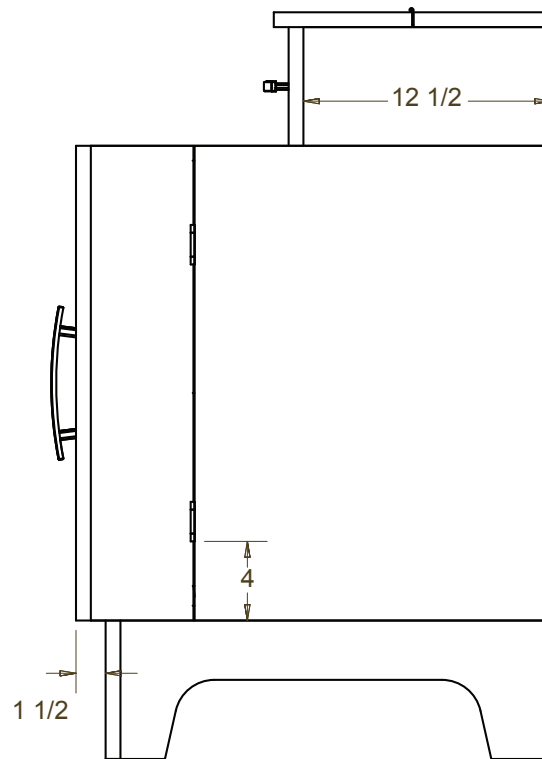

RIGHT SIDE VIEW

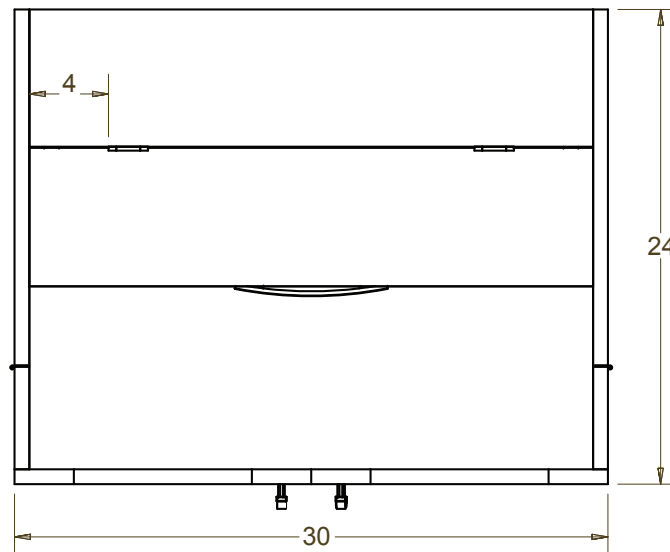

TOP VIEW

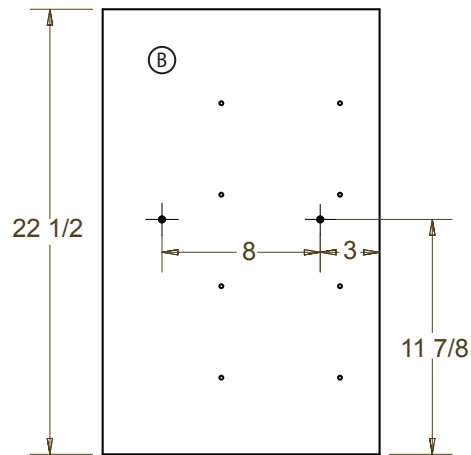
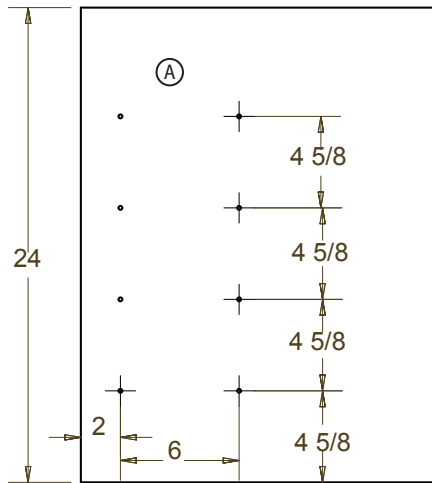
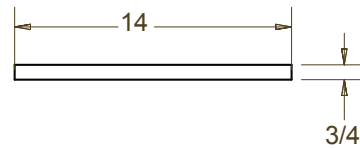
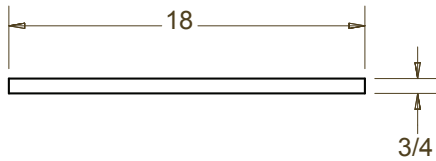

NOTE:
ALL CASE
MATERIAL
3/4" MDF

CASE SIDE LT

CASE VERT. DIVIDER LT

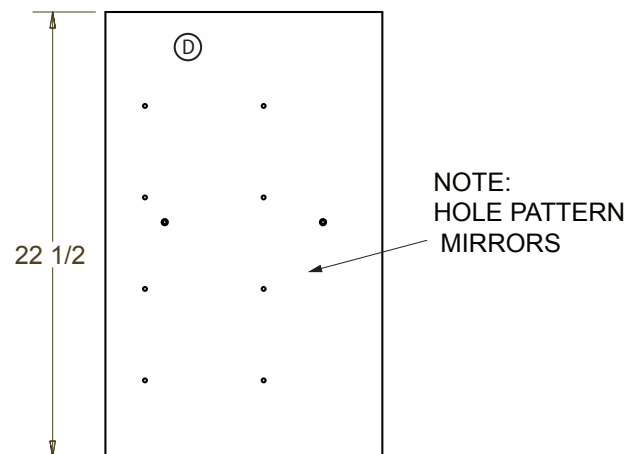
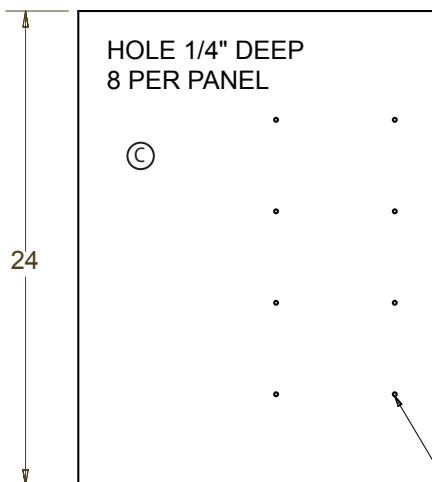
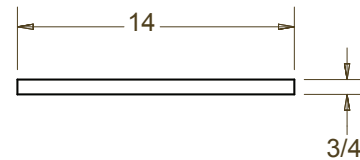
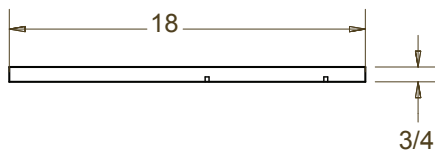

NOTE:
HOLE PATTERN
MIRRORS

CASE SIDE RT

CASE VERT. DIVIDER RT

5mm SHELF PIN

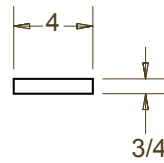
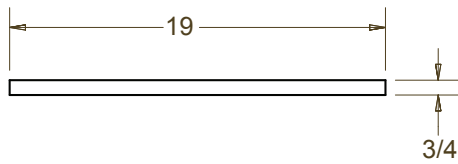

NOTE: SHELF
SAME MATERIAL
AS BASE AND TOP.

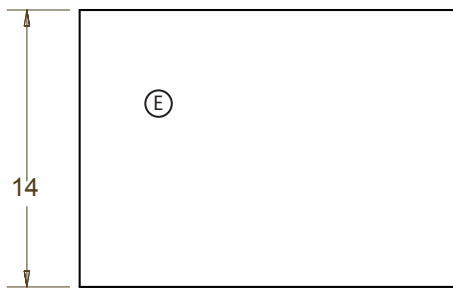

CASE FIXED SHELF

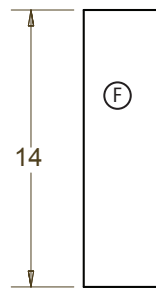

BOTTLE SHELF (8)

NOTE:
ALL CASE
MATERIAL
3/4" MDF

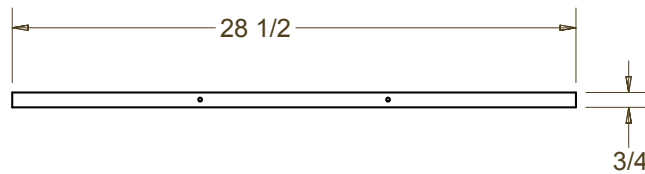

NOTE:
ALL HOLES DRILLED
AND COUNTERSUNK
FOR #8 X 1 1/4"
WOOD SCREW

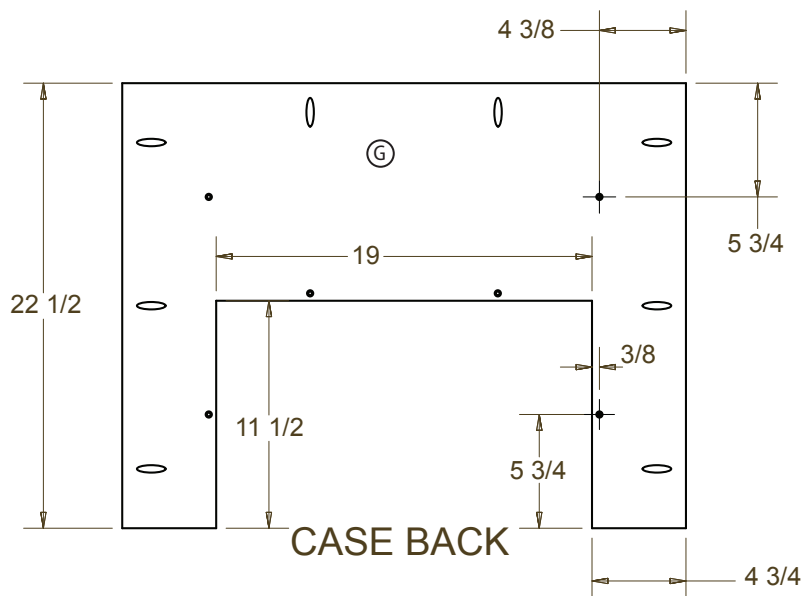

CASE BACK

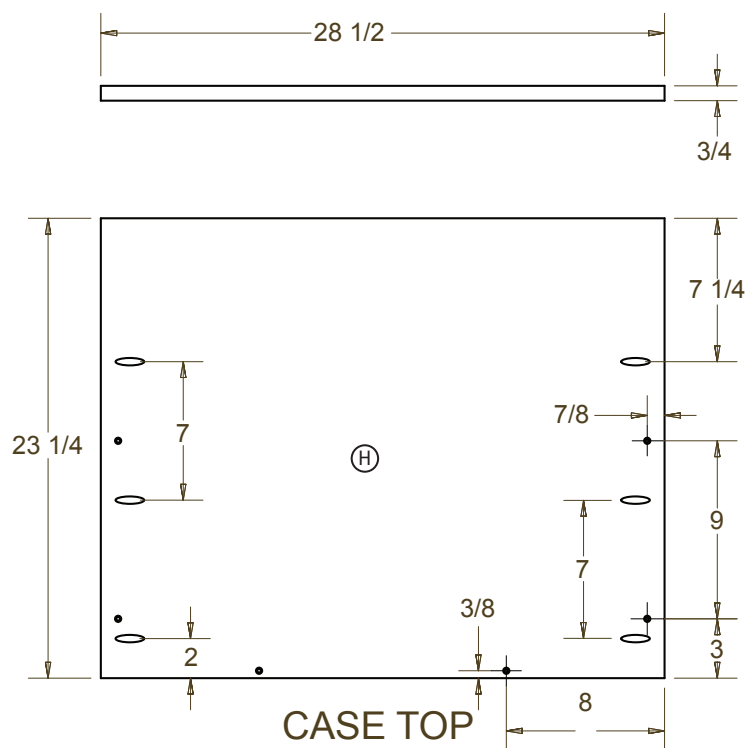

NOTE:
ALL HOLES DRILLED
AND COUNTERSUNK
FOR #8 X $1 \frac{1}{4}$ "
WOOD SCREW

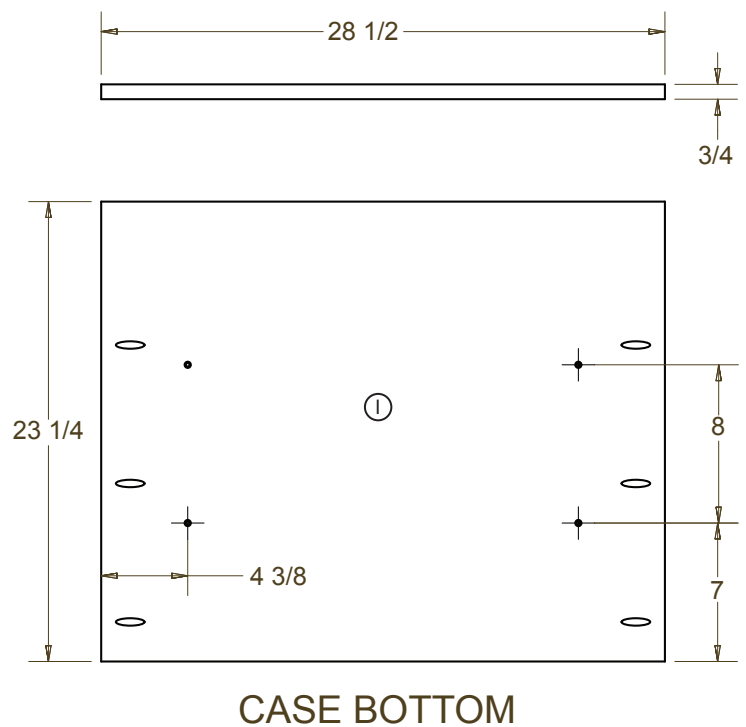

NOTE:
POCKET HOLE
SPACING SAME ON
CASE BOTTOM

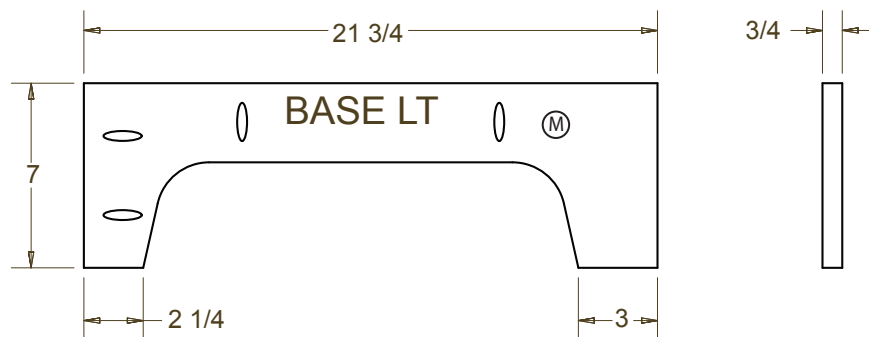
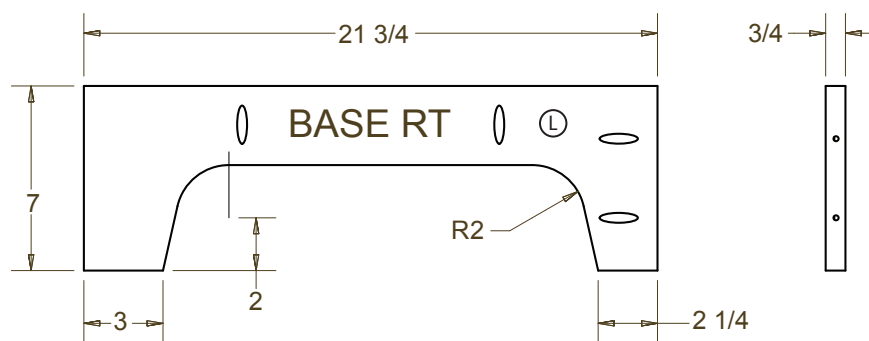
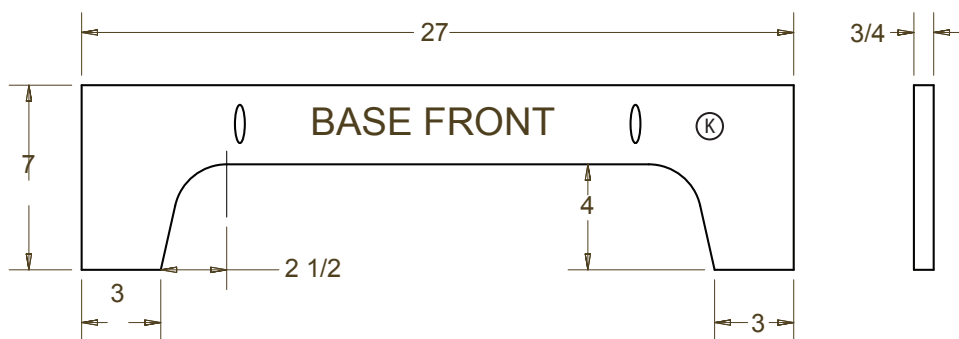
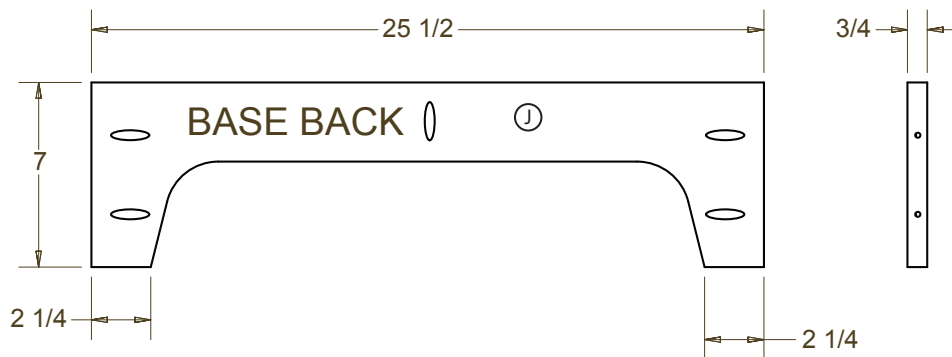

SECTION VIEW

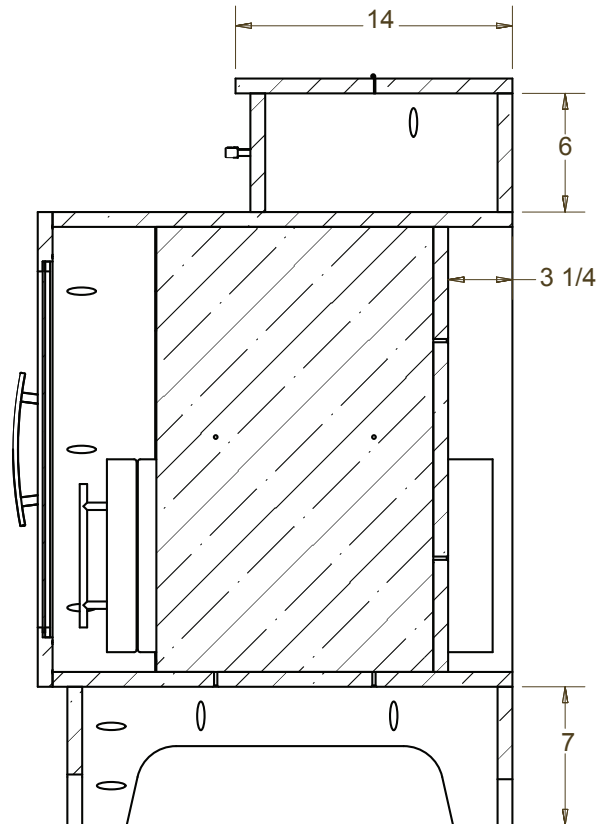

SECTION VIEW

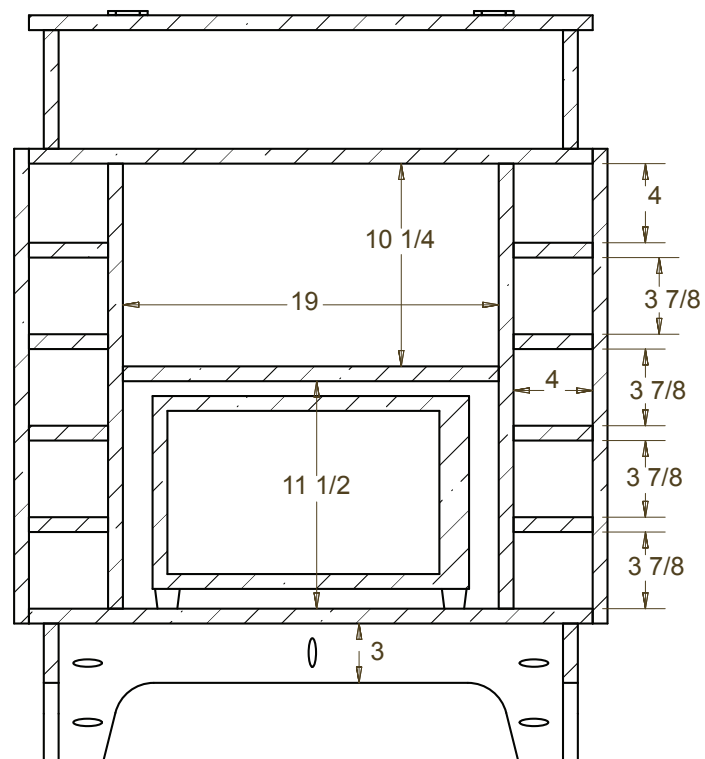

NOTE:
ALL BASE &
TOP MATERIAL
3/4" MAPLE

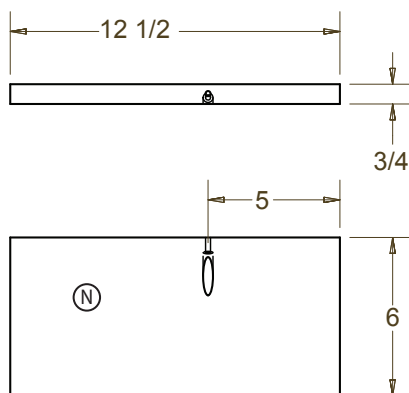

TOP SIDE LT

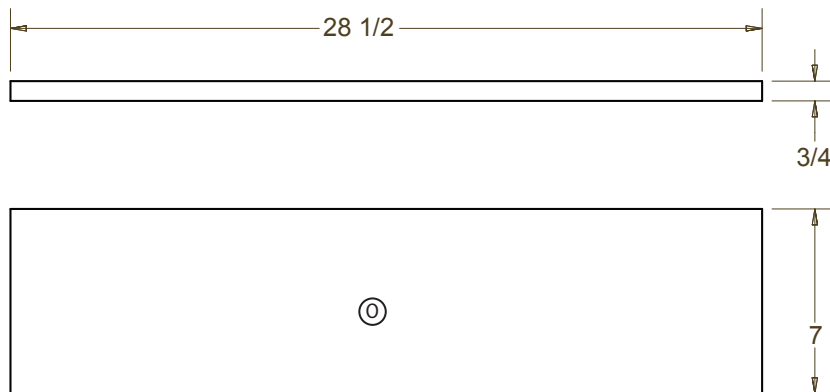

TOP HINGED PANEL

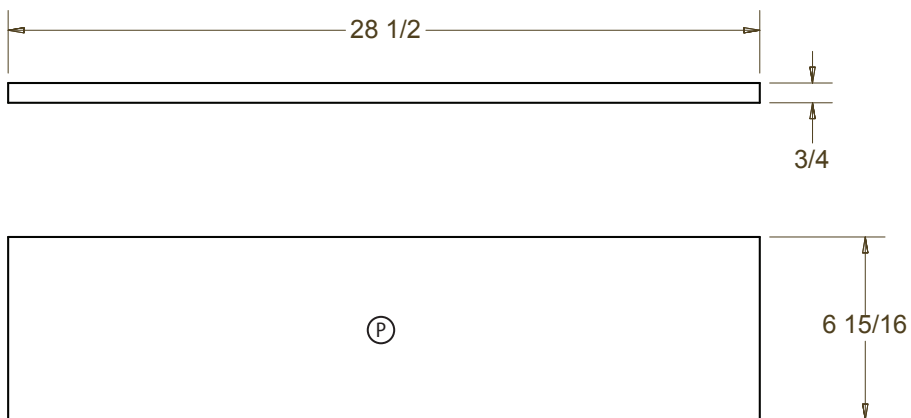

TOP FIXED PANEL

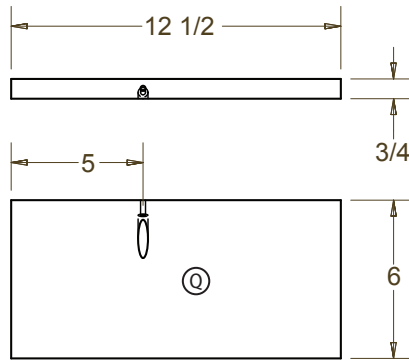

TOP SIDE RT

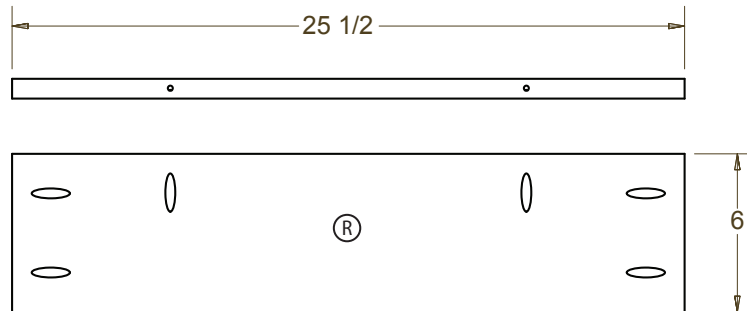

TOP BACK

NOTE:
EVENLY SPACE
POCKET SCREWS

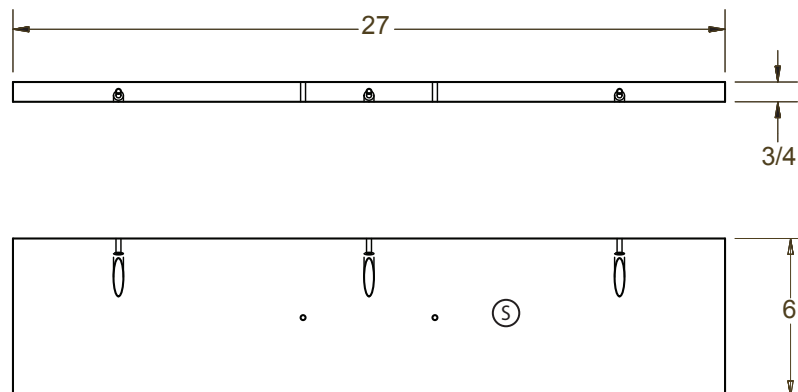

TOP FRONT

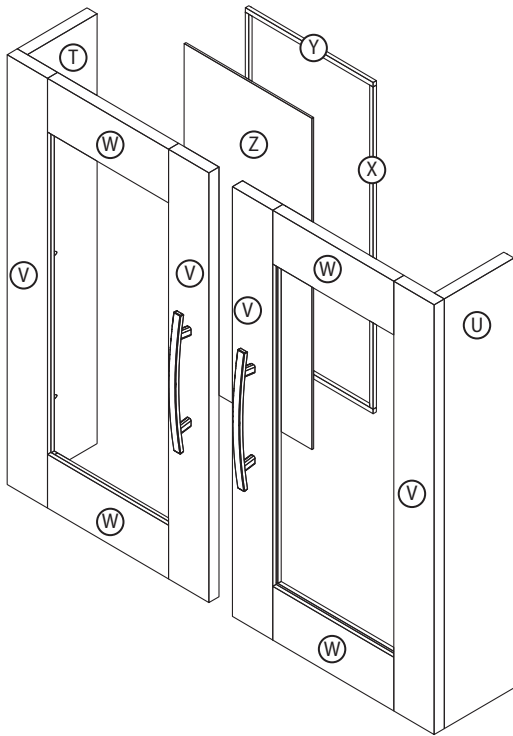

NOTE:
DOOR MATERIAL
3/4" POPLER

NOTE:
FILL ALL POCKET
SCREW HOLES
ON DOORS
BEFORE PAINTING.

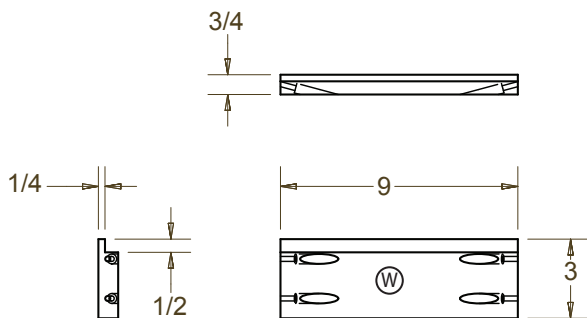
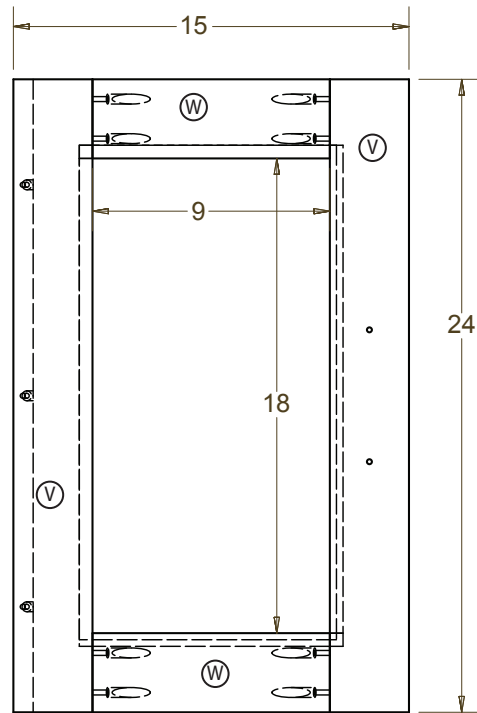

DOOR RAIL (4)

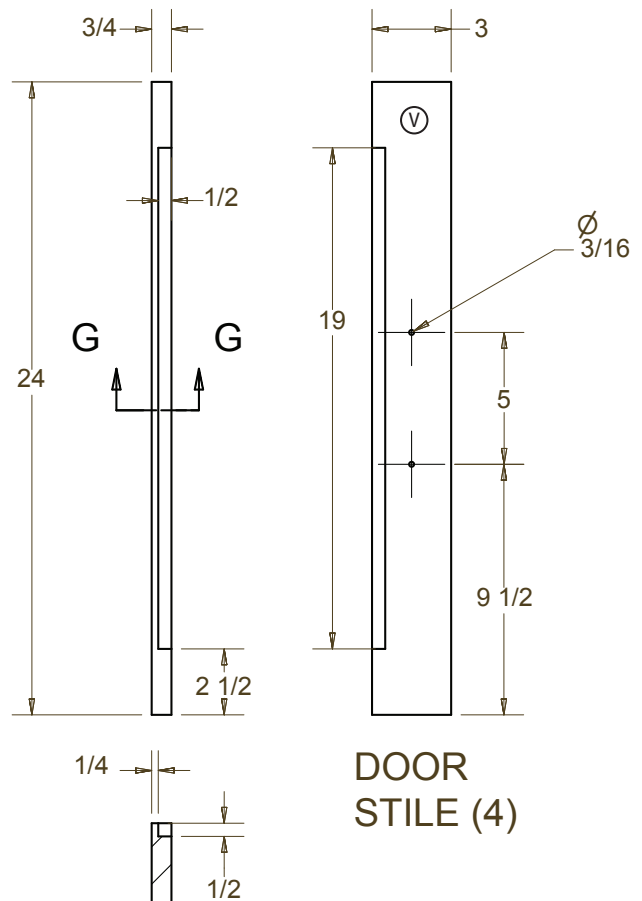

DOOR
STILE (4)

SECTION G-G

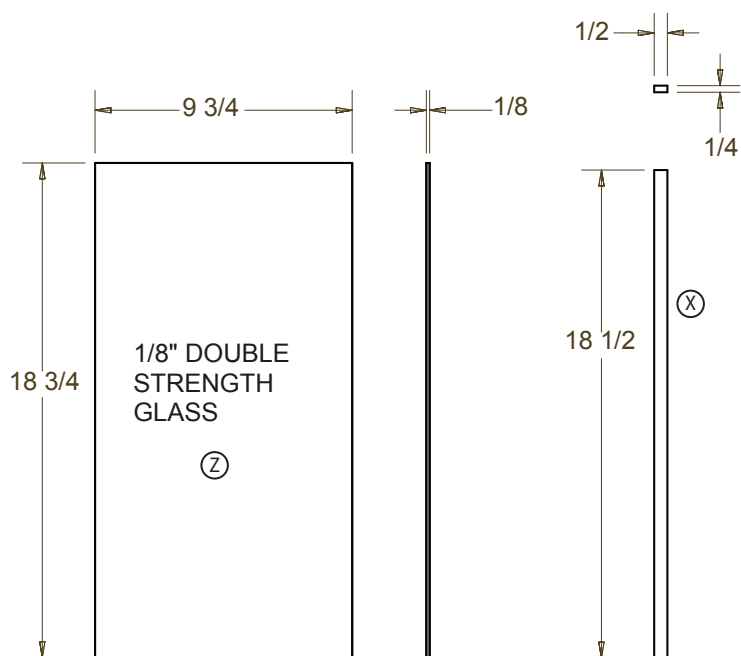

NOTE:
STOP MATERIAL 1/4"
POPLAR.
TO BE PAINTED

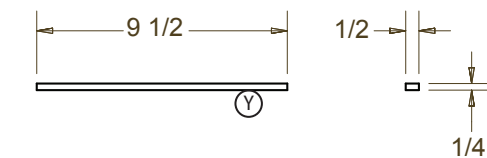

GLASS STOP HORIZ. (4)

GLASS STOP VERT. (4)

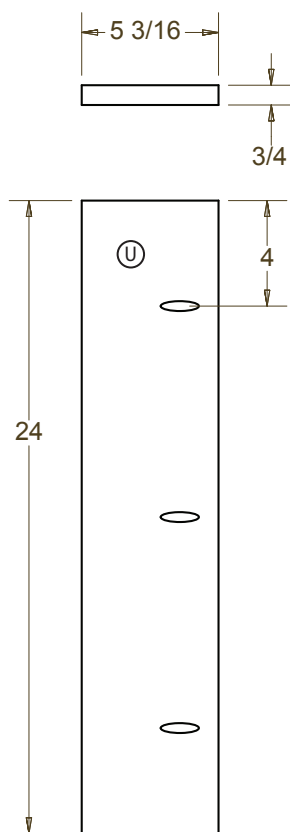

DOOR HINGE BOARD RT

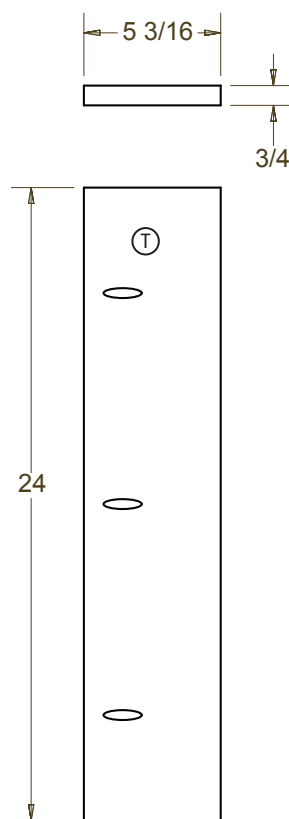

DOOR HINGE BOARD LT