



Thank You!

You have successfully downloaded your document from Workbenchmagazine.com. Below are some tips for Trouble-Free Printing

- 1)** Clear printer memory. If you are unable to print this document, turn off your printer for at least 15 seconds and try again.

- 2)** Print two or three pages at a time. If clearing the printer memory didn't help, try printing only two or three pages at one time, rather than sending the entire file

- 3)** If a document is required to be at an accurate scale set the page scaling option to "none" in your printer settings.

- 4)** Get advanced printer help. Visit Adobe Support for instructions in troubleshooting common printer problems.

<http://www.adobe.com/support/techdocs/316508.html>

workbench® Planting Guide for Raised Planter

Issue 306 Volume 64 Number 2

April 2008

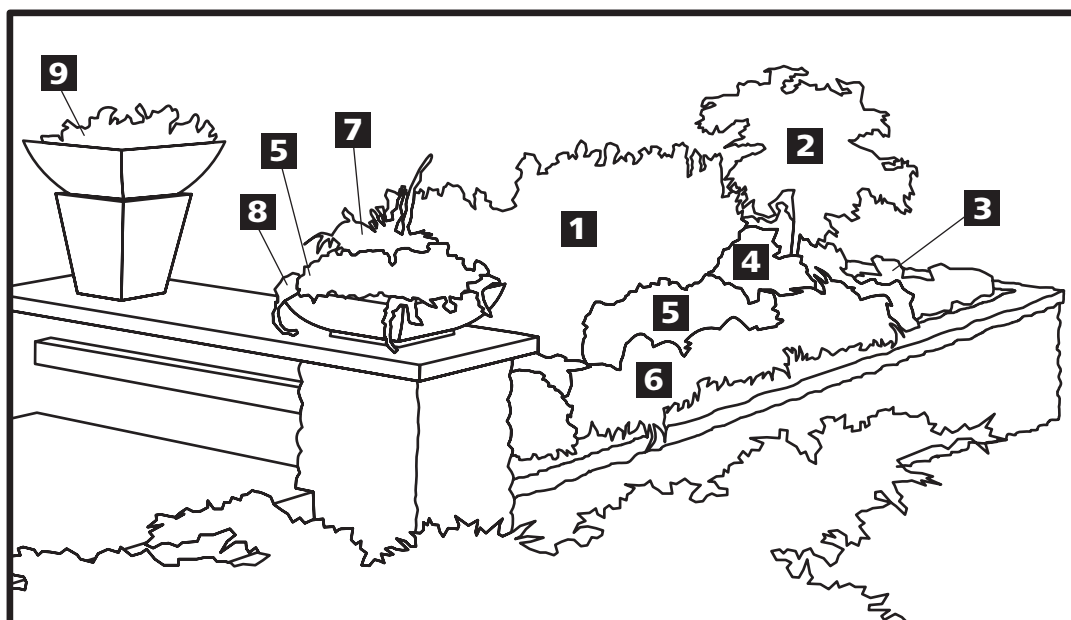
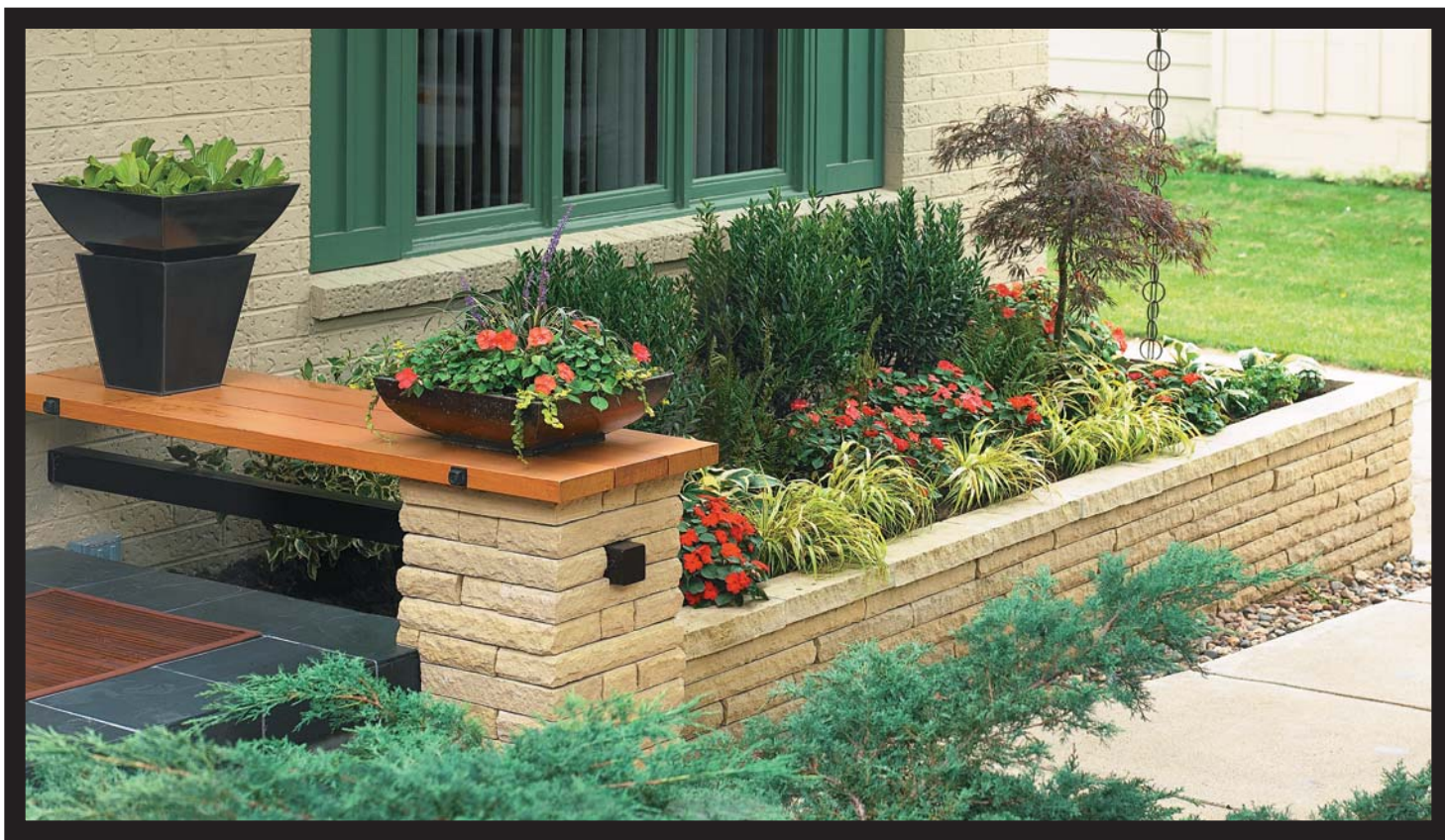

- | | |
|----------------------|---------------------------------------|
| 1. Shamrock Inkberry | 6. Golden Hakonechloa |
| 2. Japanese Maple | 7. Lilyturf |
| 3. Patriot Hosta | 8. Creeping Jenny |
| 4. Lady in Red Fern | 9. Water Lettuce (in water container) |
| 5. Red Impatiens | |