



Thank You!

You have successfully downloaded your document from Workbenchmagazine.com. Below are some tips for Trouble-Free Printing

- 1)** Clear printer memory. If you are unable to print this document, turn off your printer for at least 15 seconds and try again.

- 2)** Print two or three pages at a time. If clearing the printer memory didn't help, try printing only two or three pages at one time, rather than sending the entire file

- 3)** If a document is required to be at an accurate scale set the page scaling option to "none" in your printer settings.

- 4)** Get advanced printer help. Visit Adobe Support for instructions in troubleshooting common printer problems.

<http://www.adobe.com/support/techdocs/316508.html>

workbench® Under-Stair Storage

Issue 305 Volume 64 Number 1

February 2008



NOTE: THE HEIGHTS AND ANGLES SHOWN ARE "PERFECT WORLD" DIMENSIONS.
THESE WILL NEED TO BE CUT OVERSIZE AND FITTED ON LOCATION.

NOTE: ALL OF THESE FACE PANELS GET PAINTED

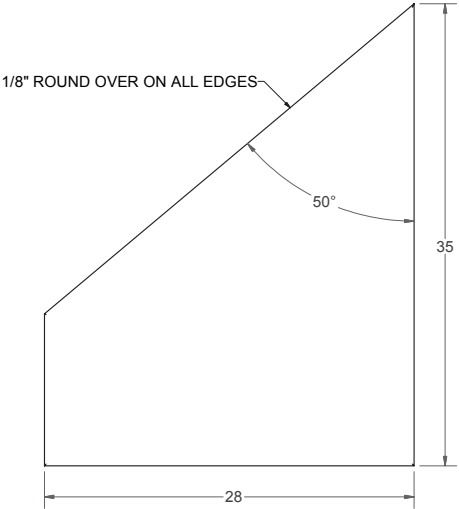

CASE #1 FRONT PANEL

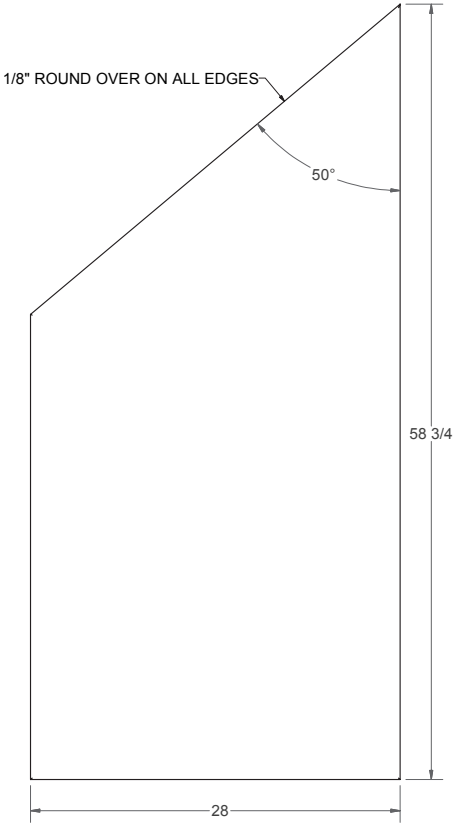

CASE #2 FRONT PANEL

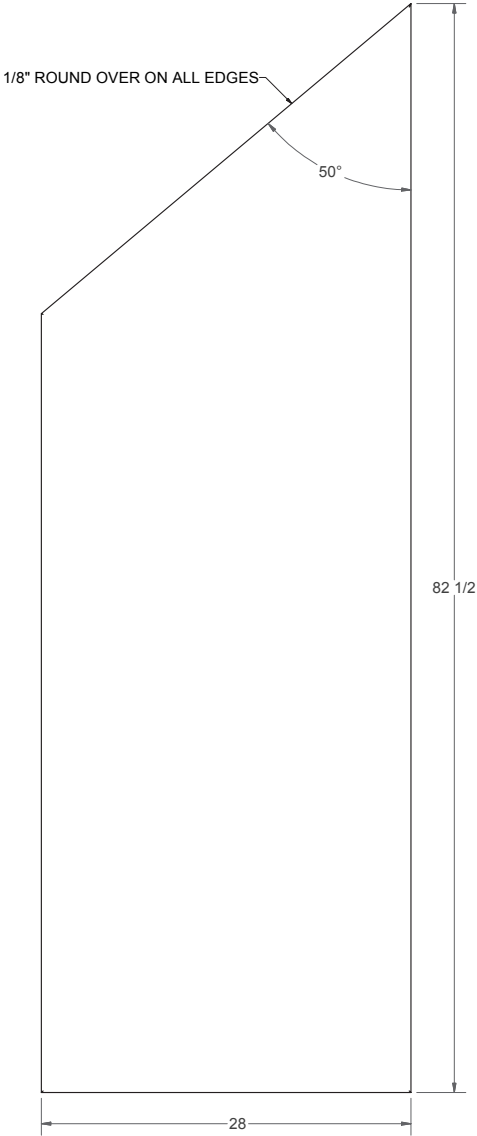

CASE #3 FRONT PANEL

Case 1

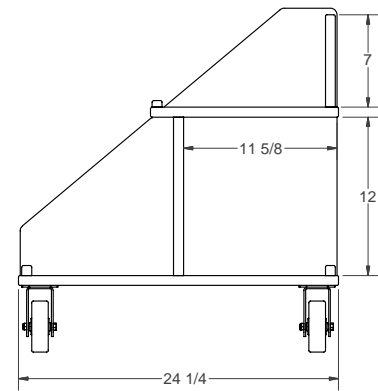
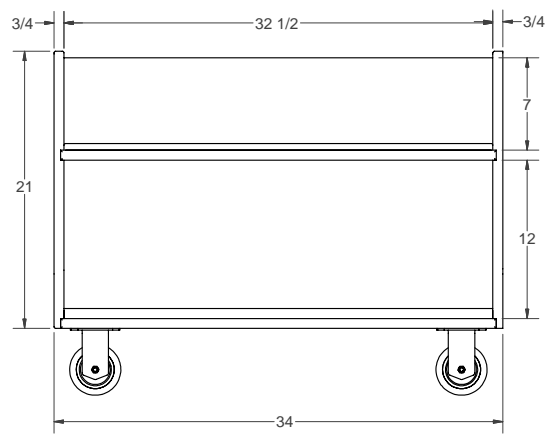
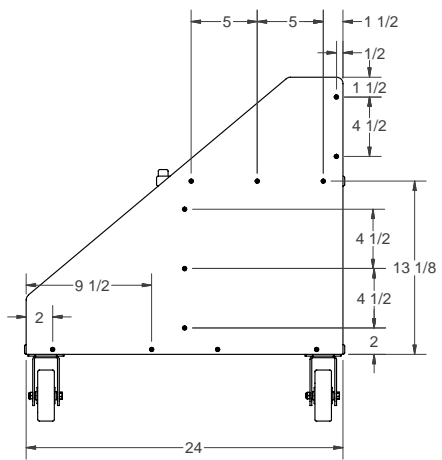

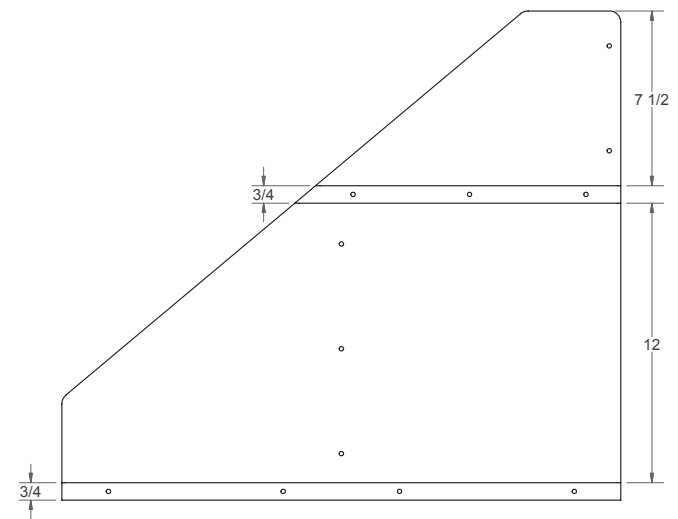
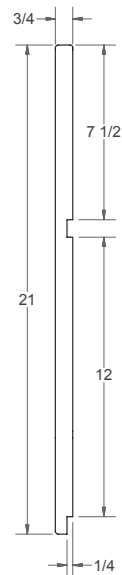
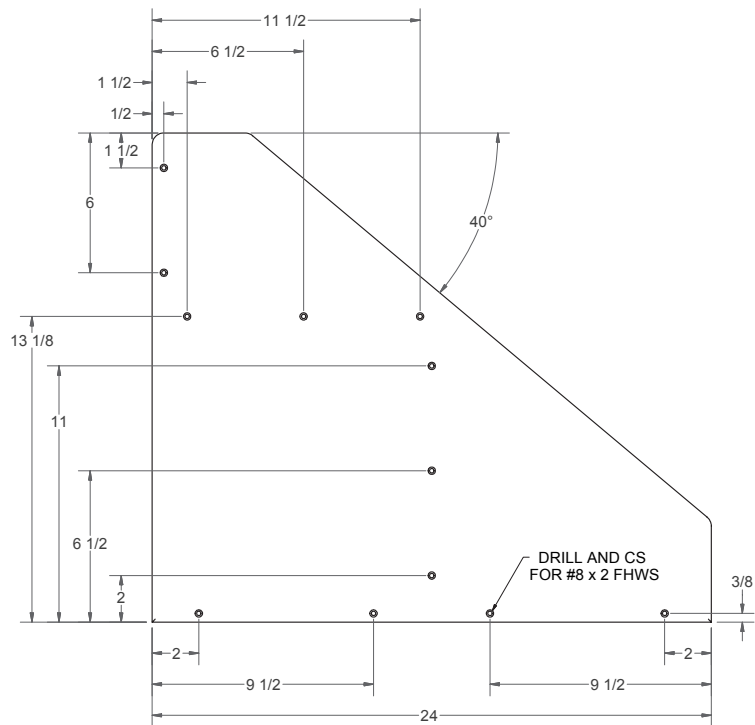

CASE #1 CABINET BACK

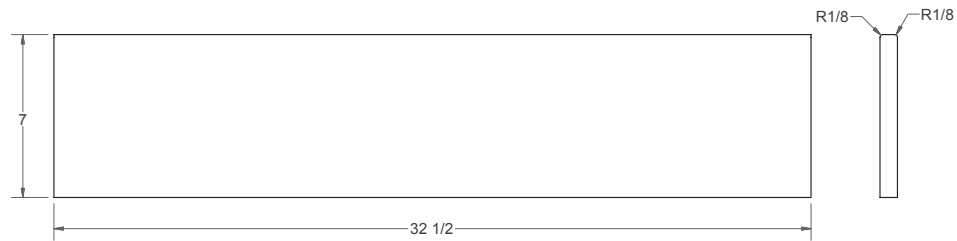

CASE #1 TOP SHELF BACKBOARD

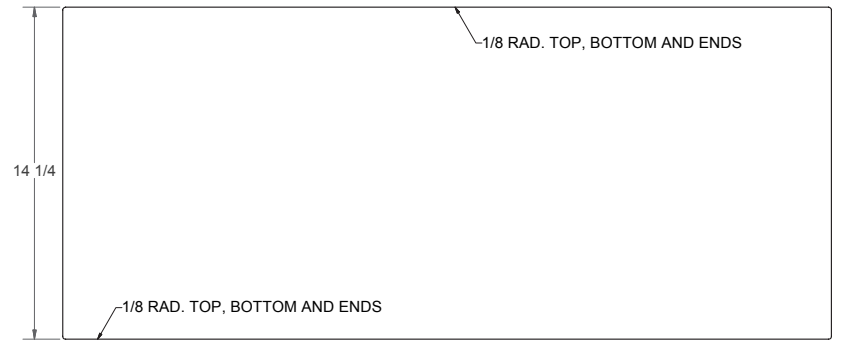
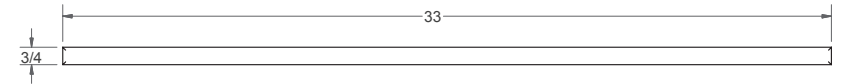
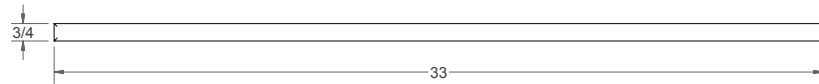

CASE # 1 TOP SHELF



CASE #1 BOTTOM PANEL

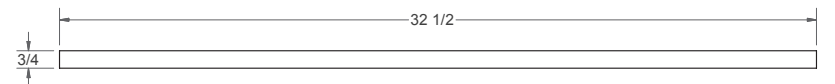

CASE #1 DIVIDER

Case 2

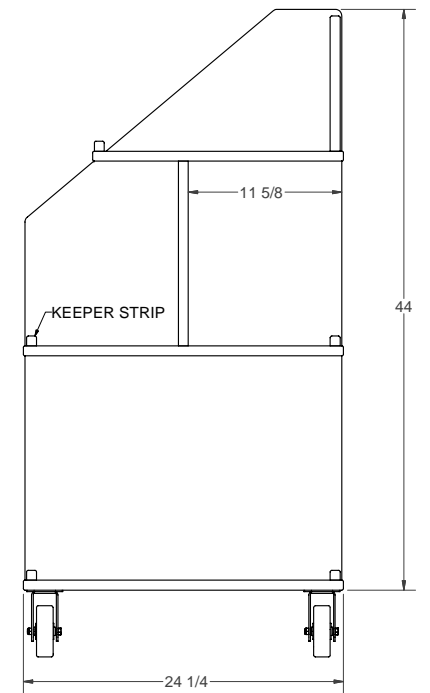
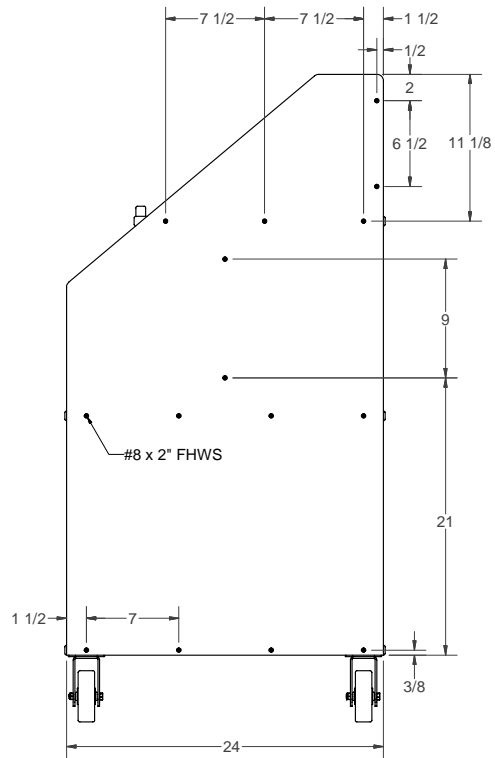
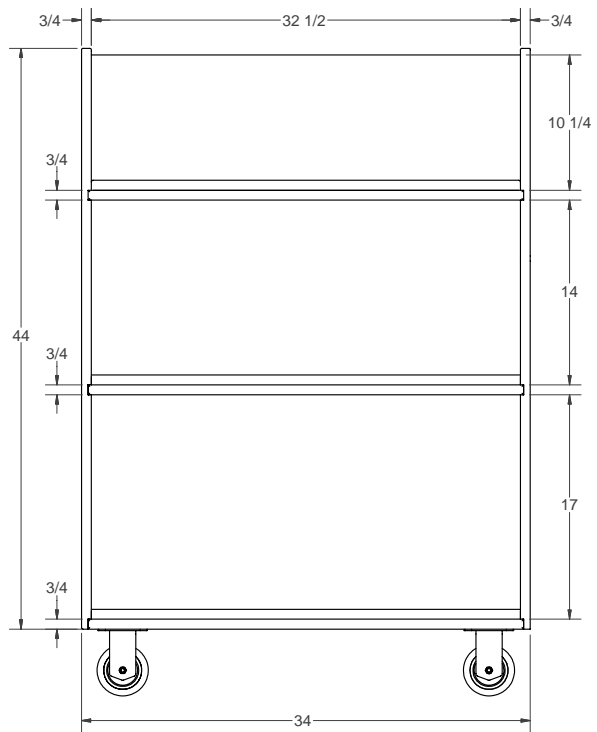

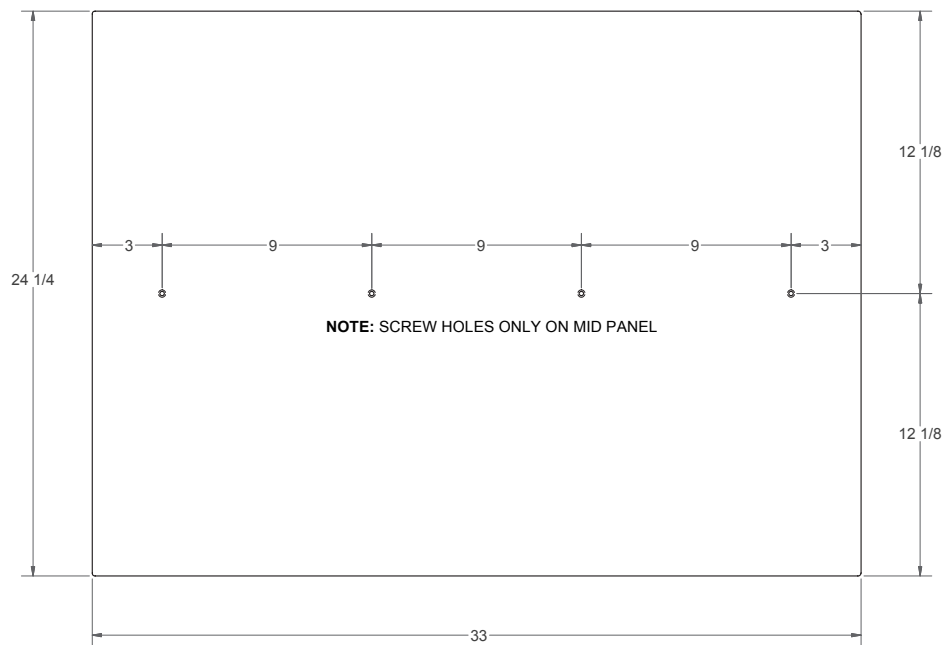
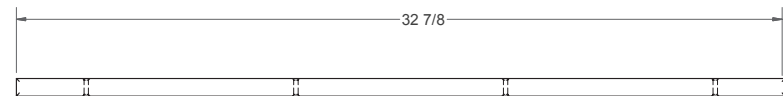
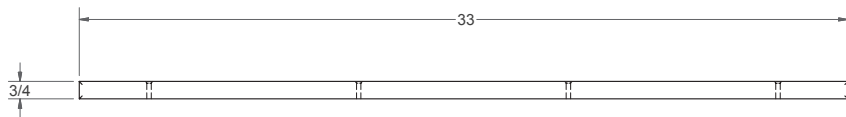

CASE #2 BOTTOM / MIDDLE PANEL

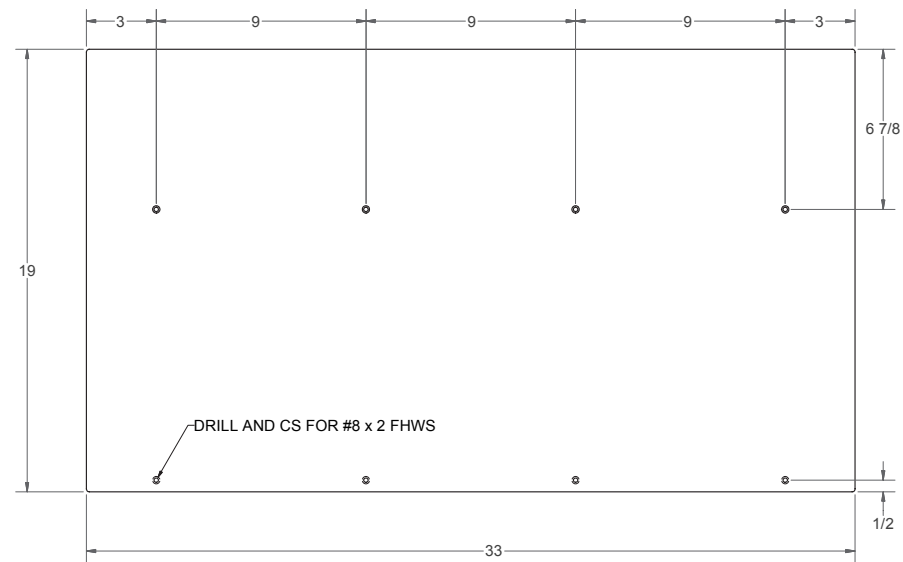

CASE #2 TOP PANEL

Case 3

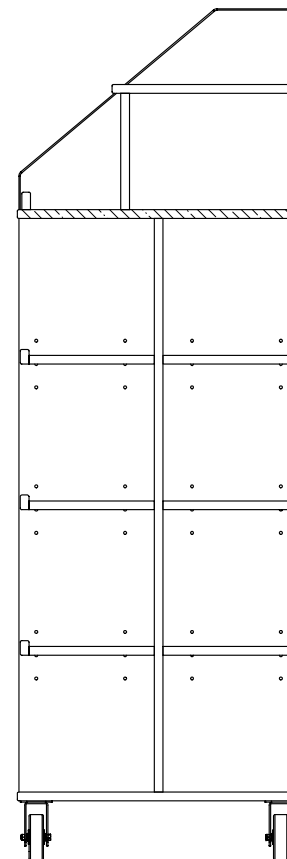
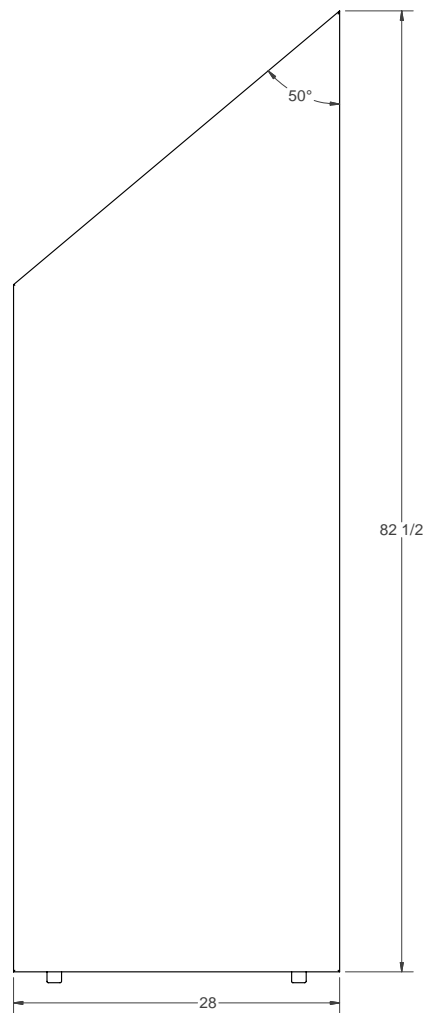
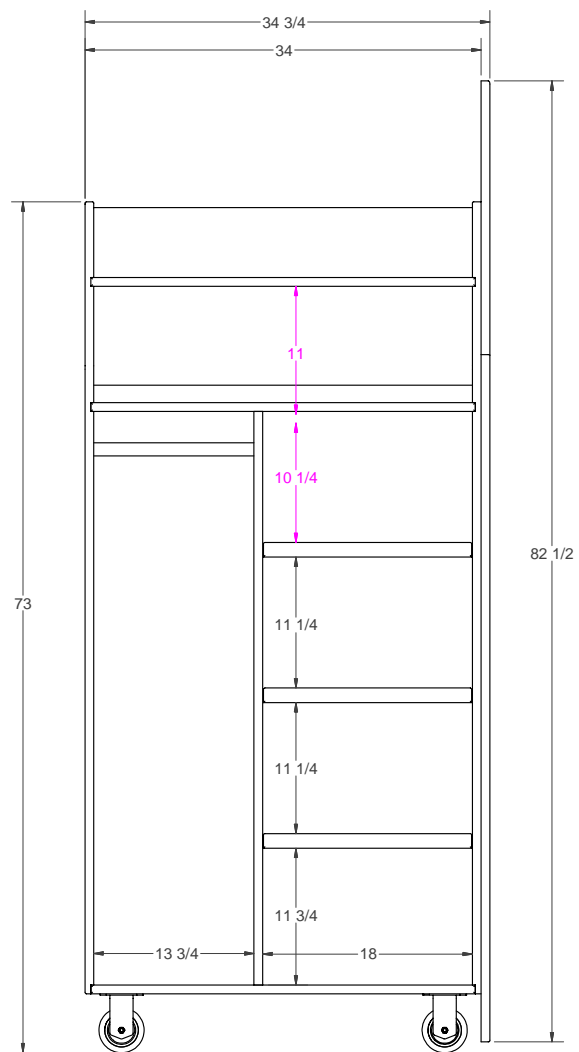

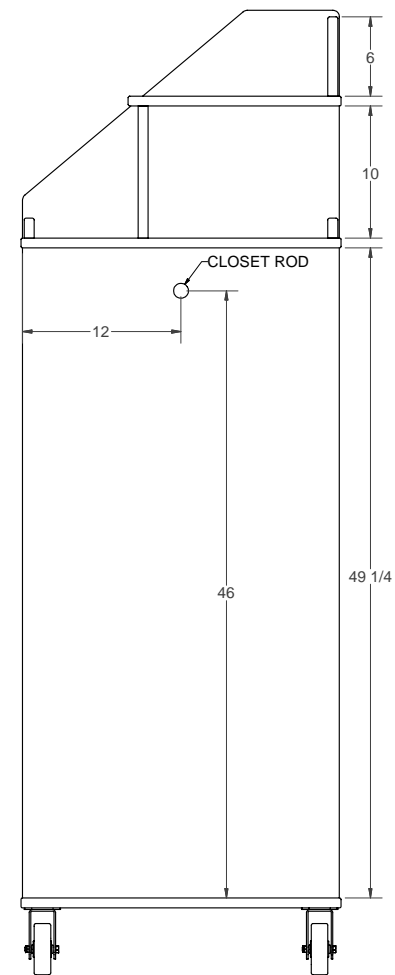
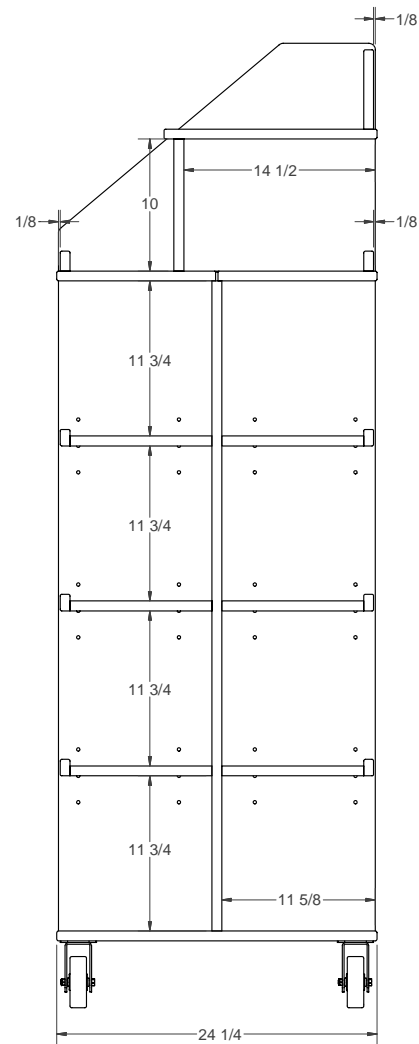
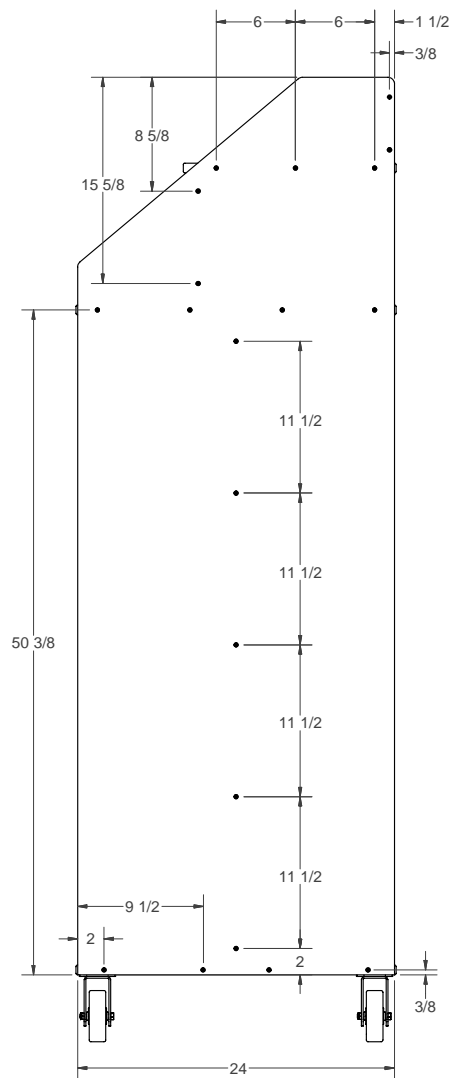
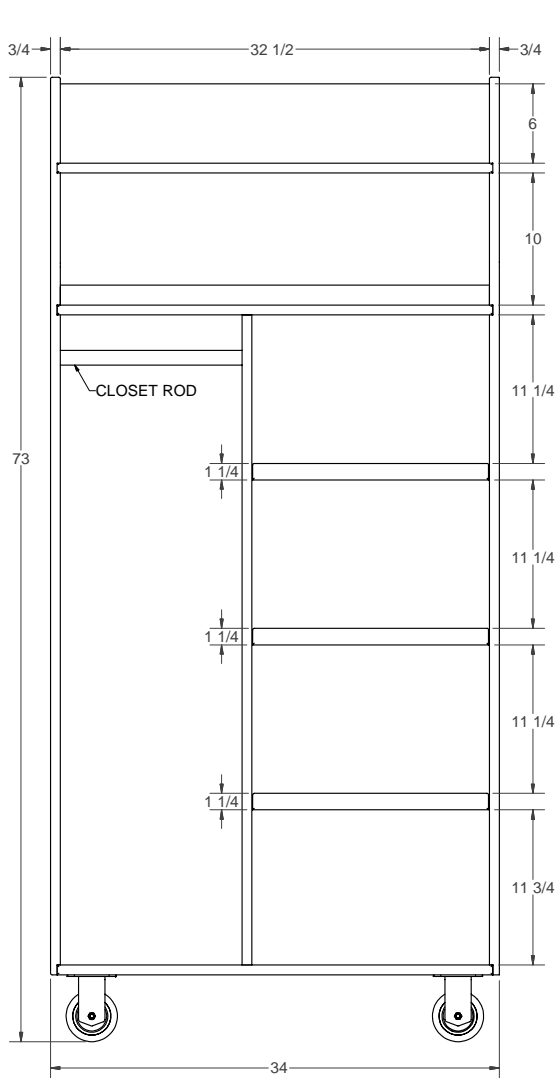

NOTE: THE FRONT PANEL GETS A 1/8" RADIUS AROUND THE PERIMETER OF THE INSIDE FACE

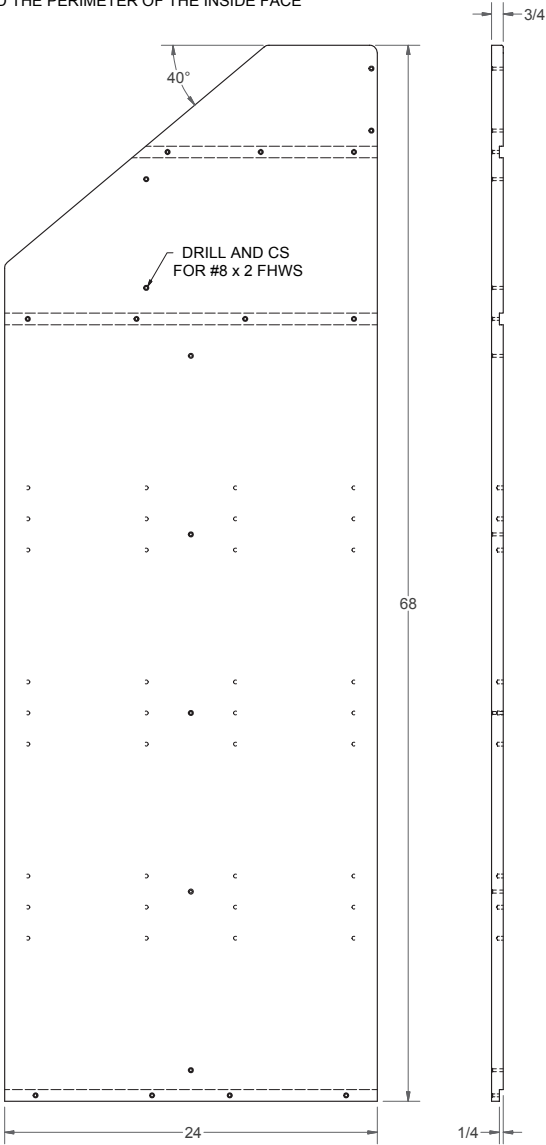

CABINET FRONT

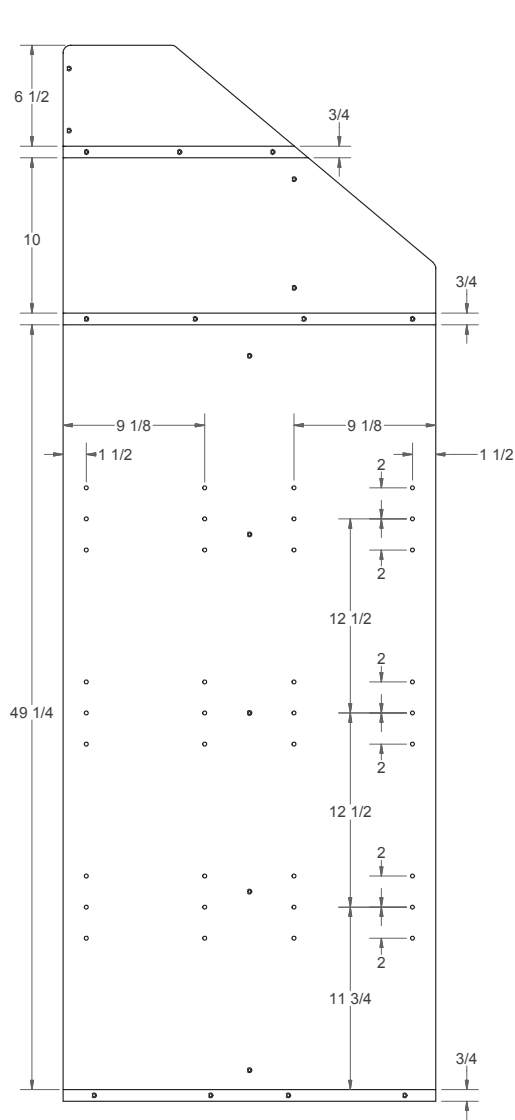

NOTE: THE BACK PANEL GETS A 1/8" RADIUS AROUND THE PERIMETER OF BOTH FACES

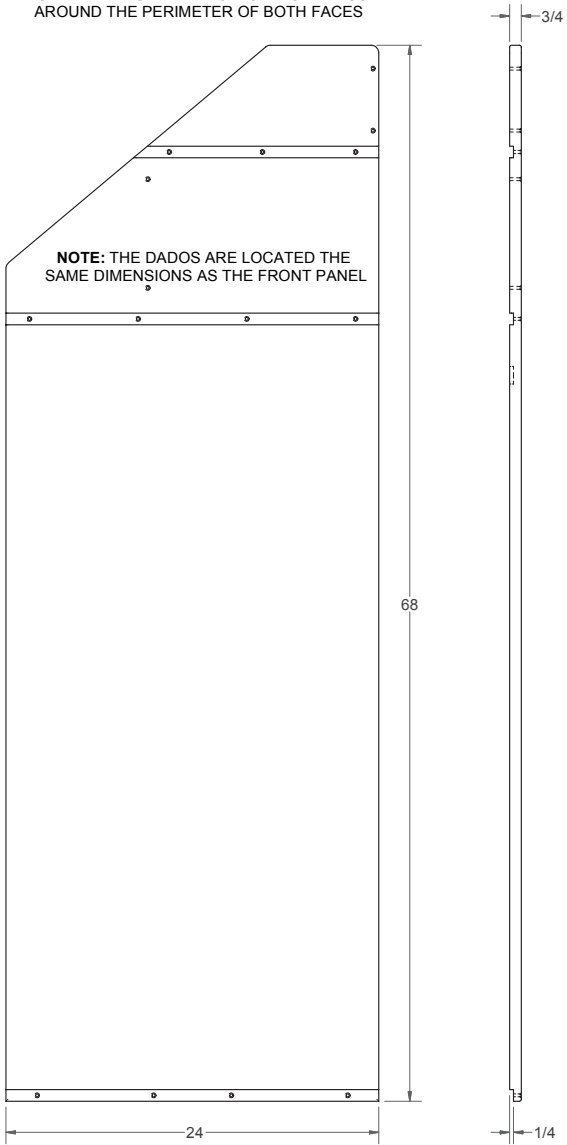

CABINET BACK

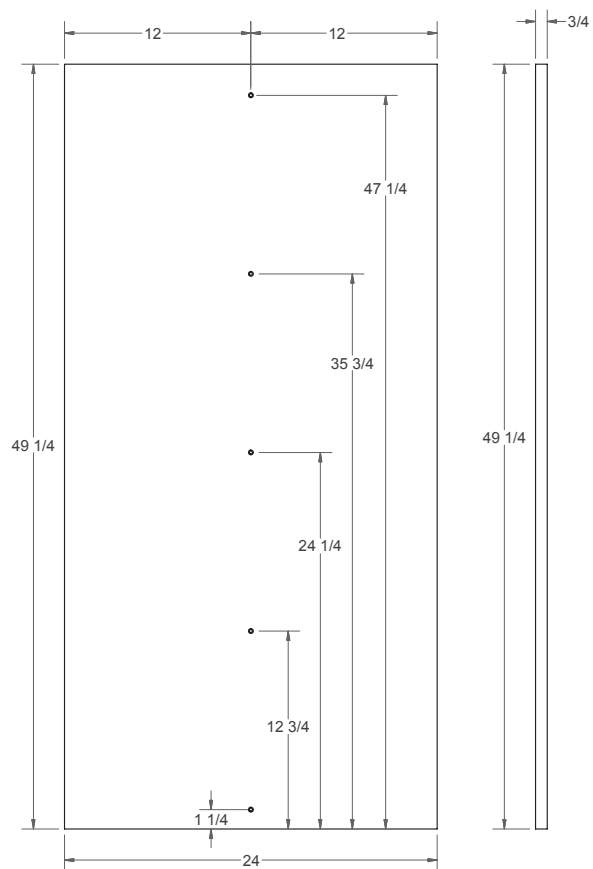

**DIVIDER PANEL
(BACK FACE)**

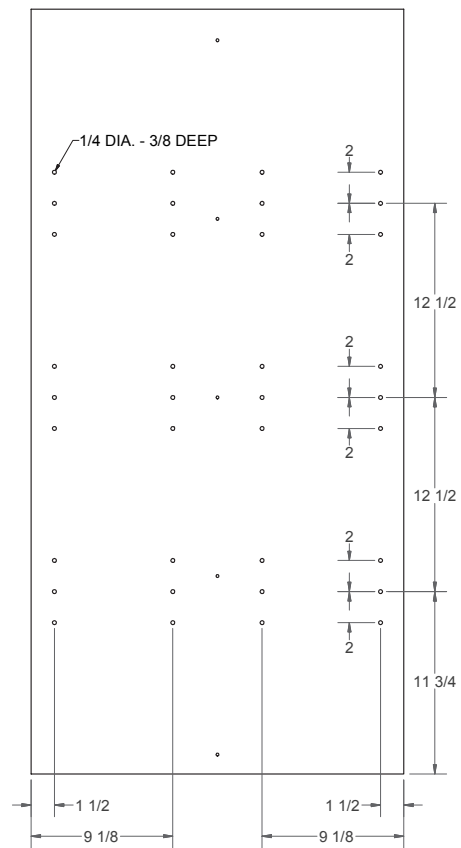

**DIVIDER
(FRONT FACE)**

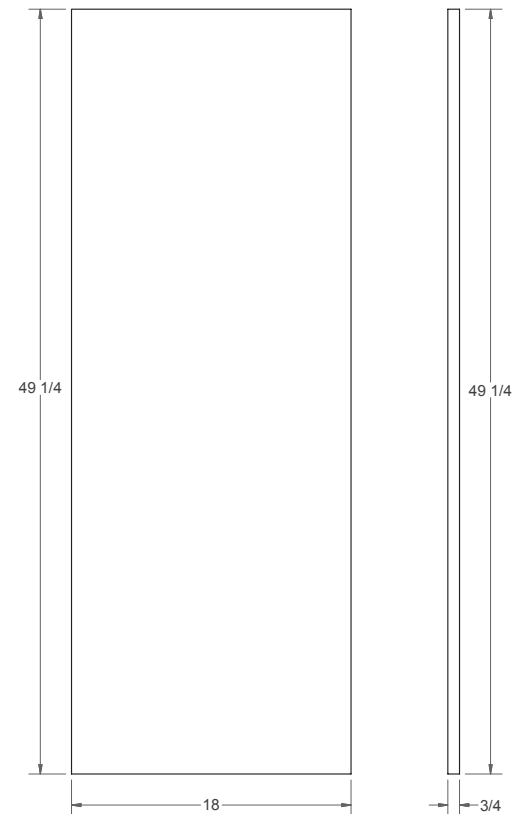

CENTER PANEL

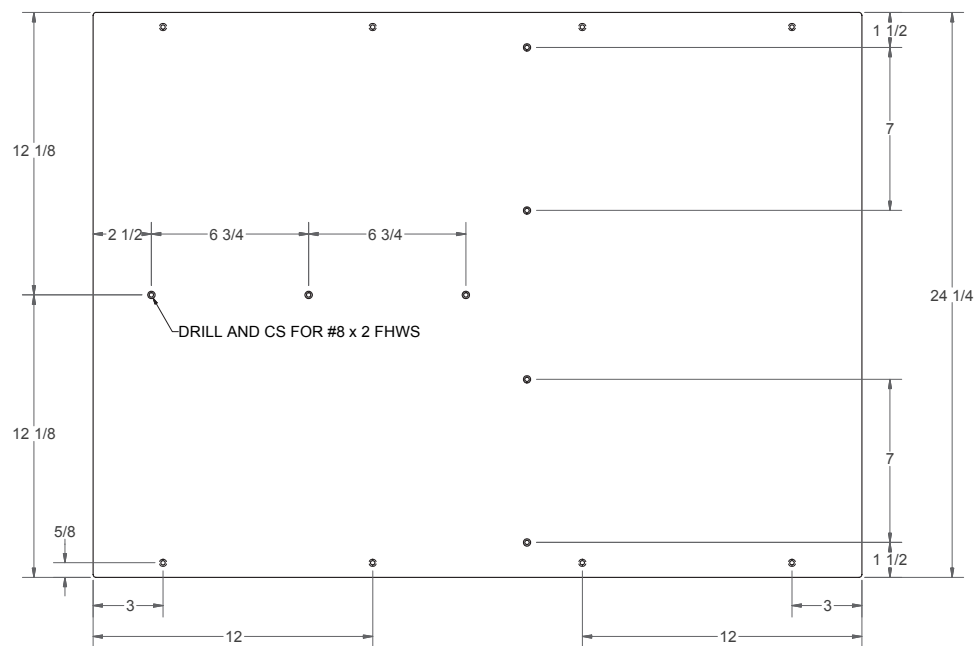

CASE #3 TOP PANEL

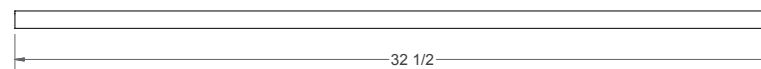
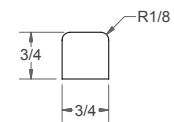

UPPER KEEPER STRIP

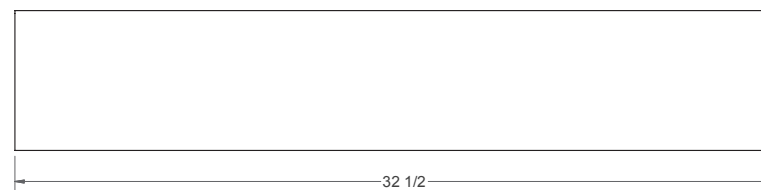

UPPER BACKBOARD

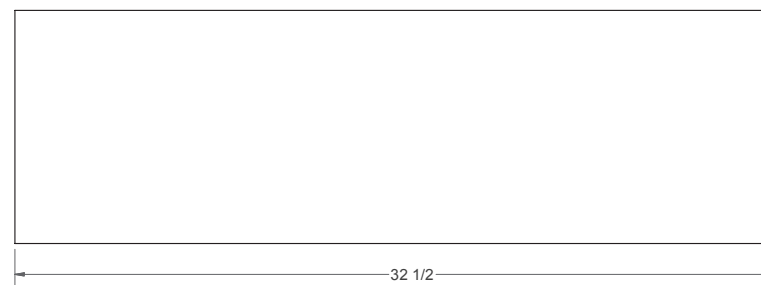
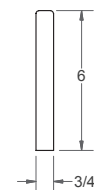

LOWER BACKBOARD



NOTE: PANEL IS 1/4 WIDER THAN THE END PANELS AND THE EDGE THAT EXTENDS GETS A 1/8 RADIUS AROUND THE PERIMETER

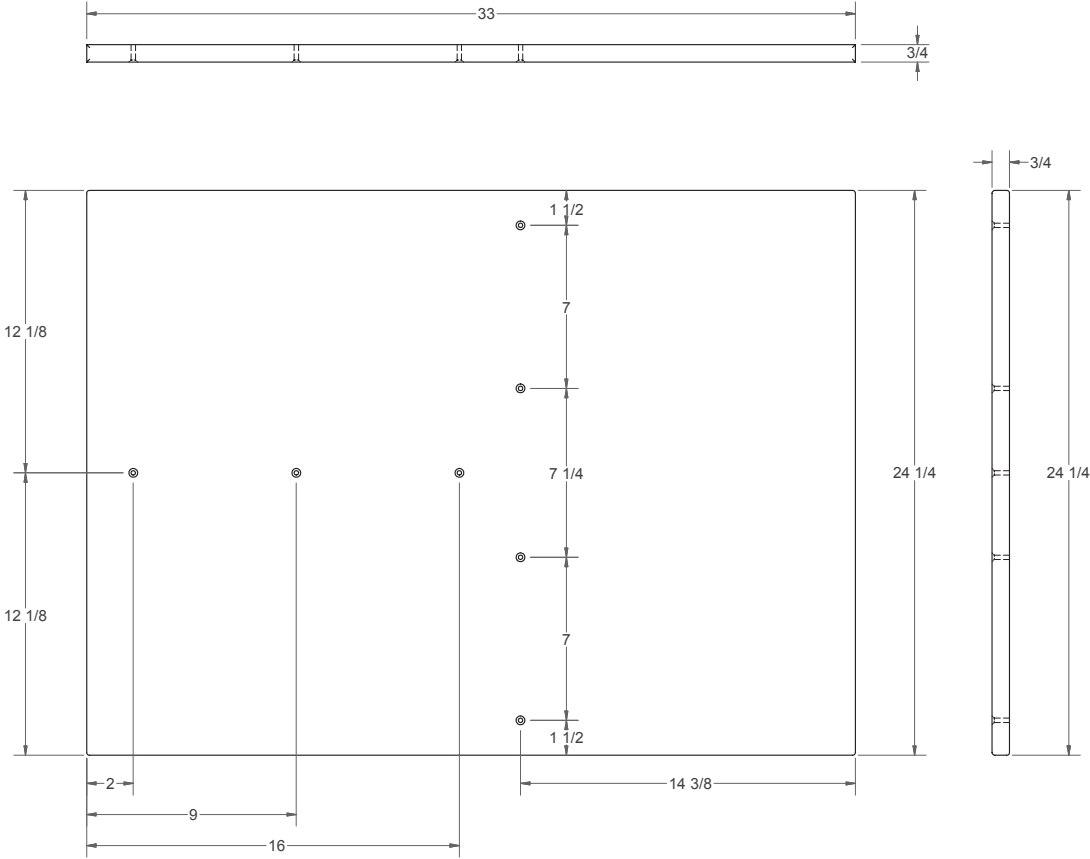

CASE #3 BOTTOM PANEL
(BOTTOM VIEW)

NOTE: PANEL IS 1/4 WIDER THAN THE END PANELS AND THE EDGE THAT EXTENDS GETS A 1/8 RADIUS AROUND THE PERIMETER



CASE #3 TOP SHELF

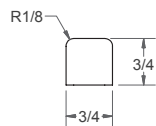

FOR THE TOP SHELF, ROUND OVER THE ENDS TOO

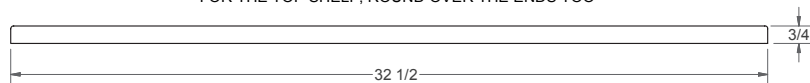

KEEPER STRIP

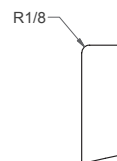

**TOP EDGE OF
BACKSPLASH**

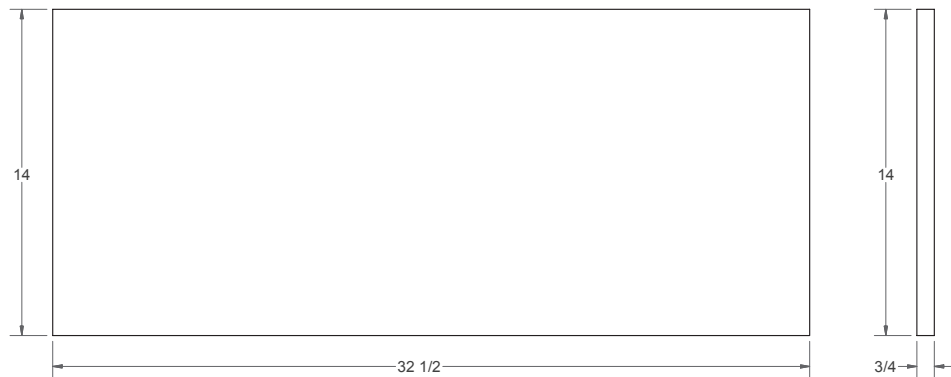

CASE DIVIDER / TOP SHELF SUPPORT



TOP BACKBOARD