



# Thank You!

---

**You have successfully downloaded your document from Workbenchmagazine.com. Below are some tips for Trouble-Free Printing**

- 1)** Clear printer memory. If you are unable to print this document, turn off your printer for at least 15 seconds and try again.
  
- 2)** Print two or three pages at a time. If clearing the printer memory didn't help, try printing only two or three pages at one time, rather than sending the entire file
  
- 3)** If a document is required to be at an accurate scale set the page scaling option to "none" in your printer settings.
  
- 4)** Get advanced printer help. Visit Adobe Support for instructions in troubleshooting common printer problems.

<http://www.adobe.com/support/techdocs/316508.html>

# workbench® Bedroom Makeover

Issue 302 Volume 63 Number 4

August 2007

## MATERIALS LIST



### MATERIAL LIST

Part	Qty	Size	Material	
WINDOW SEAT				
A	TOP PANEL	1	¾" x 24" x 63" *	Birch Plywood
B	SEAT BOX SIDES	2	¾" x 14½" x 24"	Birch Plywood
C	BACK	1	¾" x 8" x 61½" *	Birch Plywood
D	FRONT CLEAT	1	¾" x ¾" x 61½" *	Poplar
E	TOP RAIL	1	¾" x 3½" x 63" *	Poplar
F	EDGING	2	¾" x ¾" x 13¼"	Poplar
G	BIN FRONT/BACK	2	¾" x 12" x 58¾" *	Birch Plywood
H	BIN SIDES	2	¾" x 12" x 23¼"	Birch Plywood
I	BIN BOTTOM	1	¾" x 21¾" x 58¾" *	Birch Plywood
J	BOTTOM RAIL	1	⅝" x 4" x 61¼" *	Poplar
K	BEADBOARD	1	⅜" x 8¾" x 61¼" *	Beadboard **
DAYBED				
A	TOP PANEL	1	¾" x 41" x 77"	Birch Plywood
B	BOX SIDES	2	¾" x 15½" x 41"	Birch Plywood
C	BACK	1	¾" x 8" x 75½"	Birch Plywood
D	FRONT CLEAT	1	¾" x ¾" x 77"	Poplar
E	TOP RAIL	1	¾" x 5" x 77"	Poplar
F	FRONT PANEL	1	¾" x 14¾" x 75"	Birch Plywood
G	BOTTOM RAIL	1	⅝" x 4" x 76½"	Poplar
H	BEADBOARD	1	⅜" x 10¾" x 76½"	Beadboard **

\* **NOTE:** Length of parts will vary based on size of opening. Size the Top Panel (A)  $\frac{1}{2}$ " shorter than width of opening. Then adjust the length of other parts marked with an asterisk accordingly.

\*\* **NOTE:** The beadboard used for this project can be the same as that used for the bedroom wainscoting ([NewEnglandClassic.com](http://NewEnglandClassic.com)). A suitable substitute is a PVC beadboard available at Home Depot that comes in 7 $\frac{1}{4}$ "-wide pieces. Butt the PVC pieces together edge-to-edge to fill the desired space.

#### HARDWARE:

- (115) #8 x 1 $\frac{1}{4}$ " Fh Woodscrews
- (1) 4-pack of Bed Box Rollers (#71597) \*
- (1) Duralink Trundle-Bed Frame \*\*
- (2)  $\frac{1}{2}$ " Rare Earth Magnets (#30810), Cups (#31668), & Washers (#37474) \*
- (2)  $\frac{3}{8}$ "-dia. Dowels,  $\frac{3}{4}$ " long
- (6)  $\frac{1}{4}$ " Carriage Bolts, 1" long
- (6)  $\frac{1}{4}$ " Nuts & Washers
- (4) Knobs

\* Items available from Rockler (800-279-4441, [Rockler.com](http://Rockler.com))

\*\* Item available from Humble Abode (877-692-2633, [HumbleAbode.com](http://HumbleAbode.com))

CUTTING DIAGRAM - WINDOW SEAT

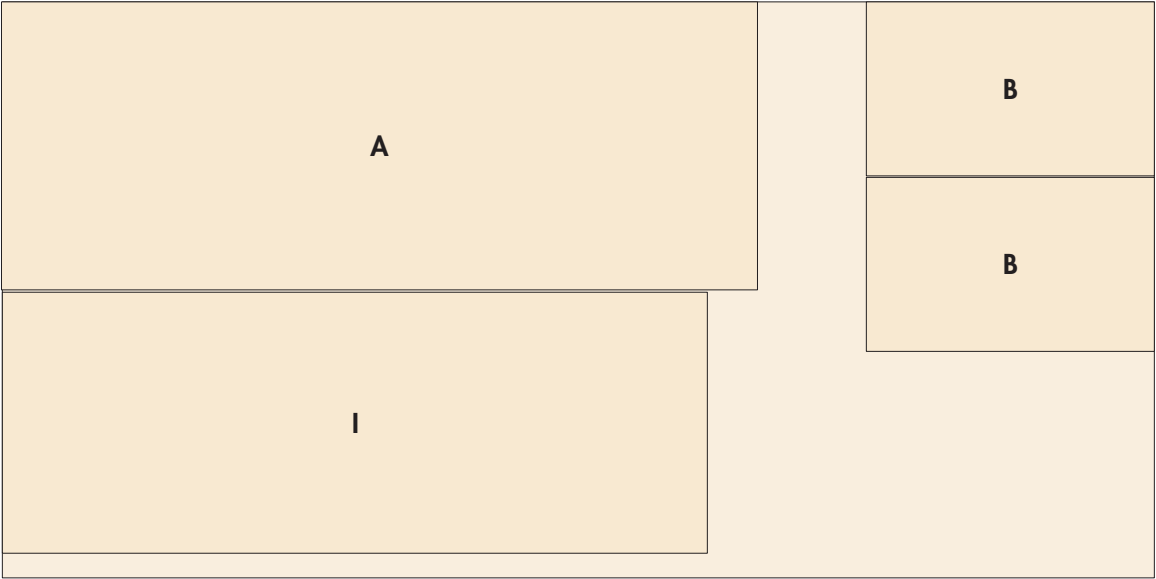

¾" x 48" x 96" Birch Plywood

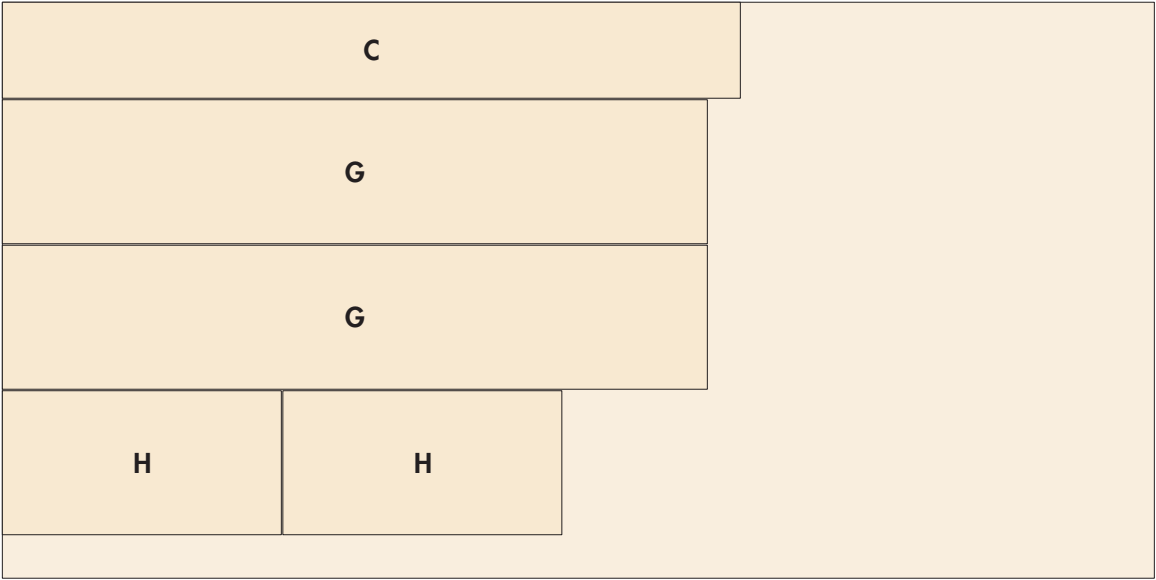

¾" x 48" x 96" Birch Plywood

CUTTING DIAGRAM - WINDOW SEAT



3/4" x 3 1/2" x 96" Poplar

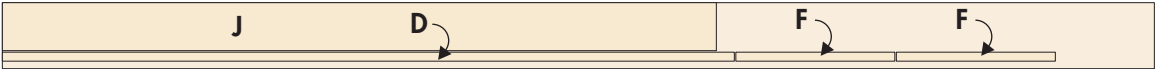

3/4" x 5 1/2" x 96" Poplar

K	K	K	K	K	K	K	K	K	

1/4" x 7 1/4" x 96" Beadboard Planking

CUTTING DIAGRAM - DAYBED

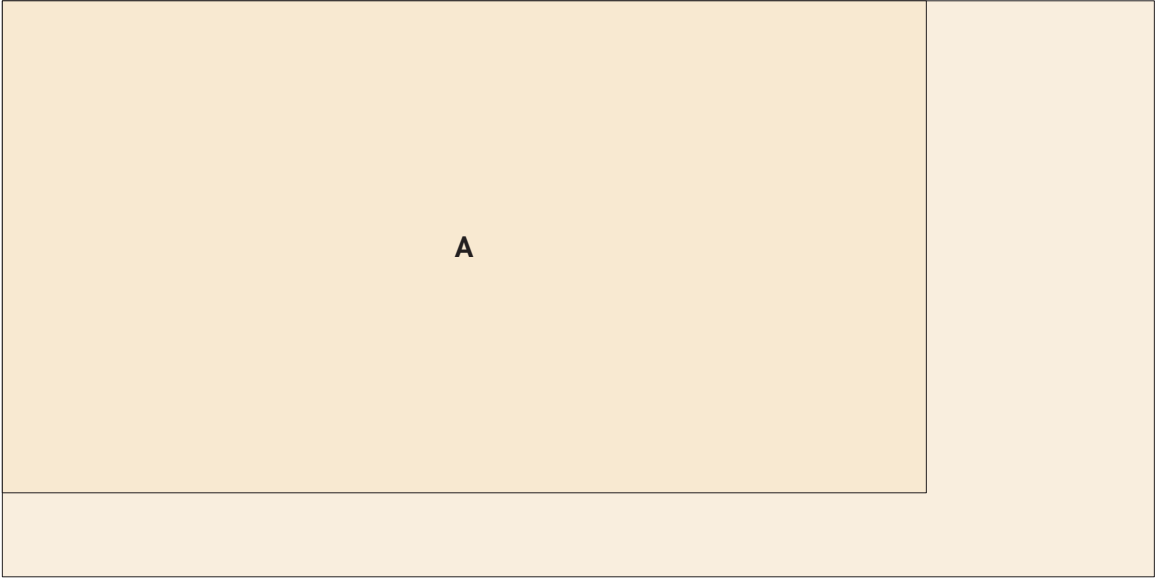

¾" x 48" x 96" Birch Plywood

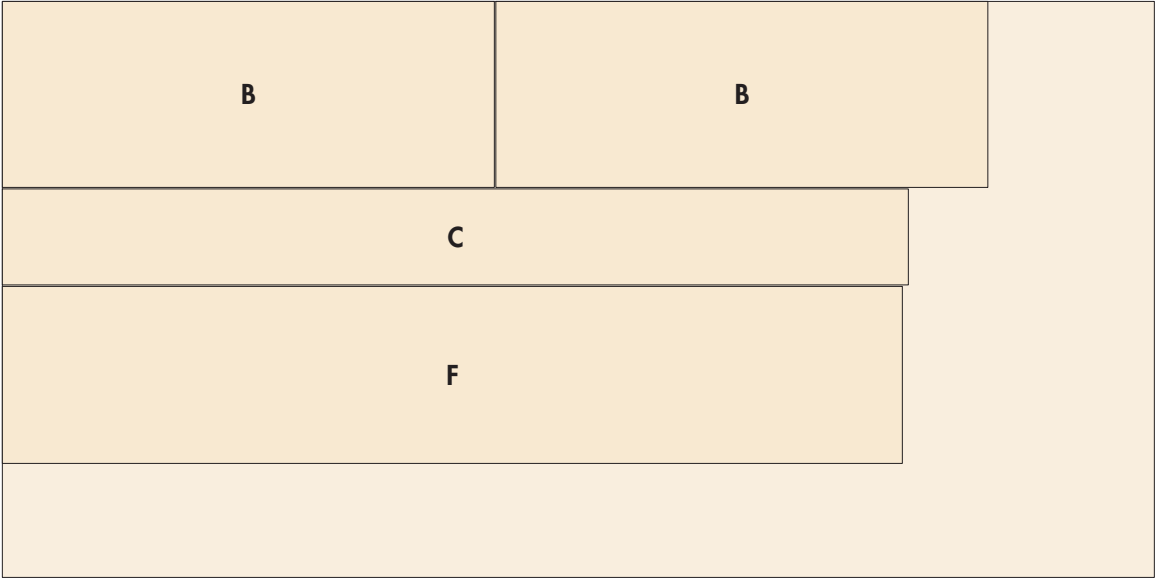

¾" x 48" x 96" Birch Plywood

CUTTING DIAGRAM - DAYBED

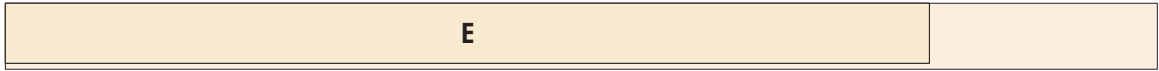

3/4" x 5 1/2" x 96" Poplar

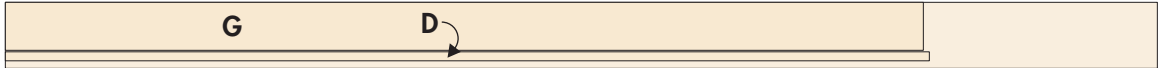

3/4" x 5 1/2" x 96" Poplar

H	H	H	H	H	H	H	H	

1/4" x 7 1/4" x 96" Beadboard Planking

H	H	H	

1/4" x 7 1/4" x 96" Beadboard Planking

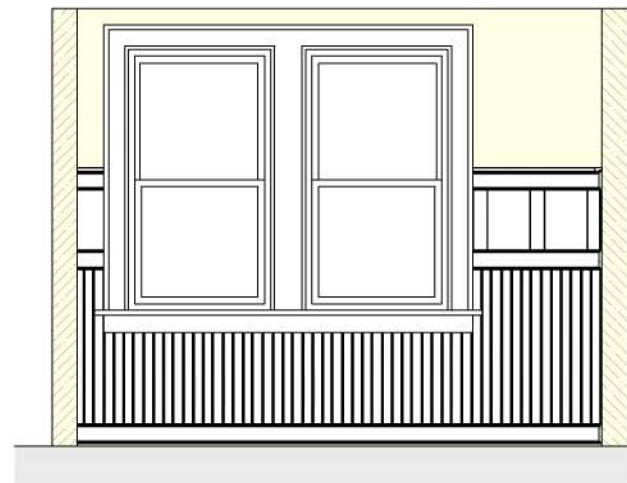
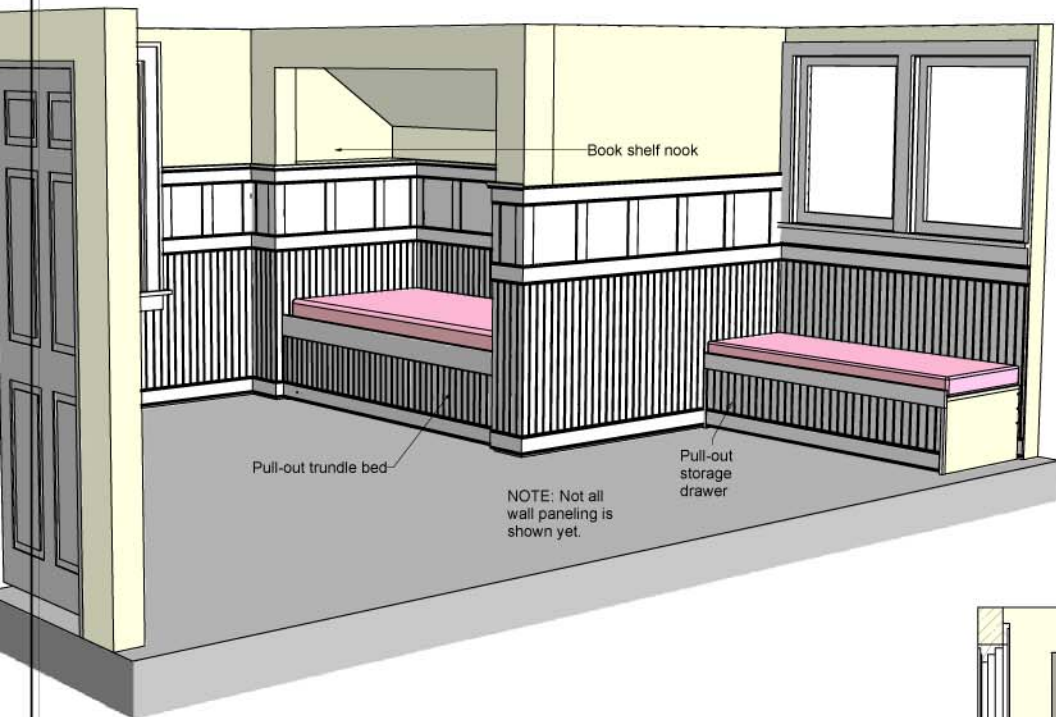

**SOUTH ELEVATION**

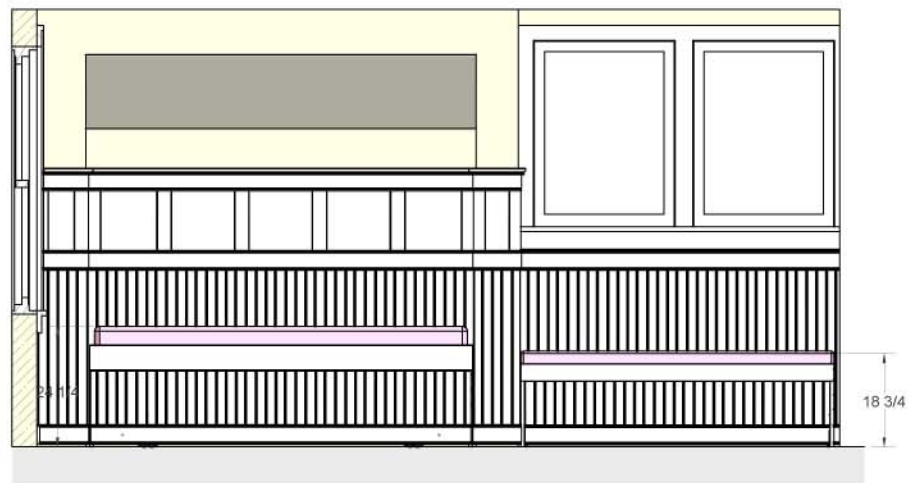

**WEST ELEVATION**

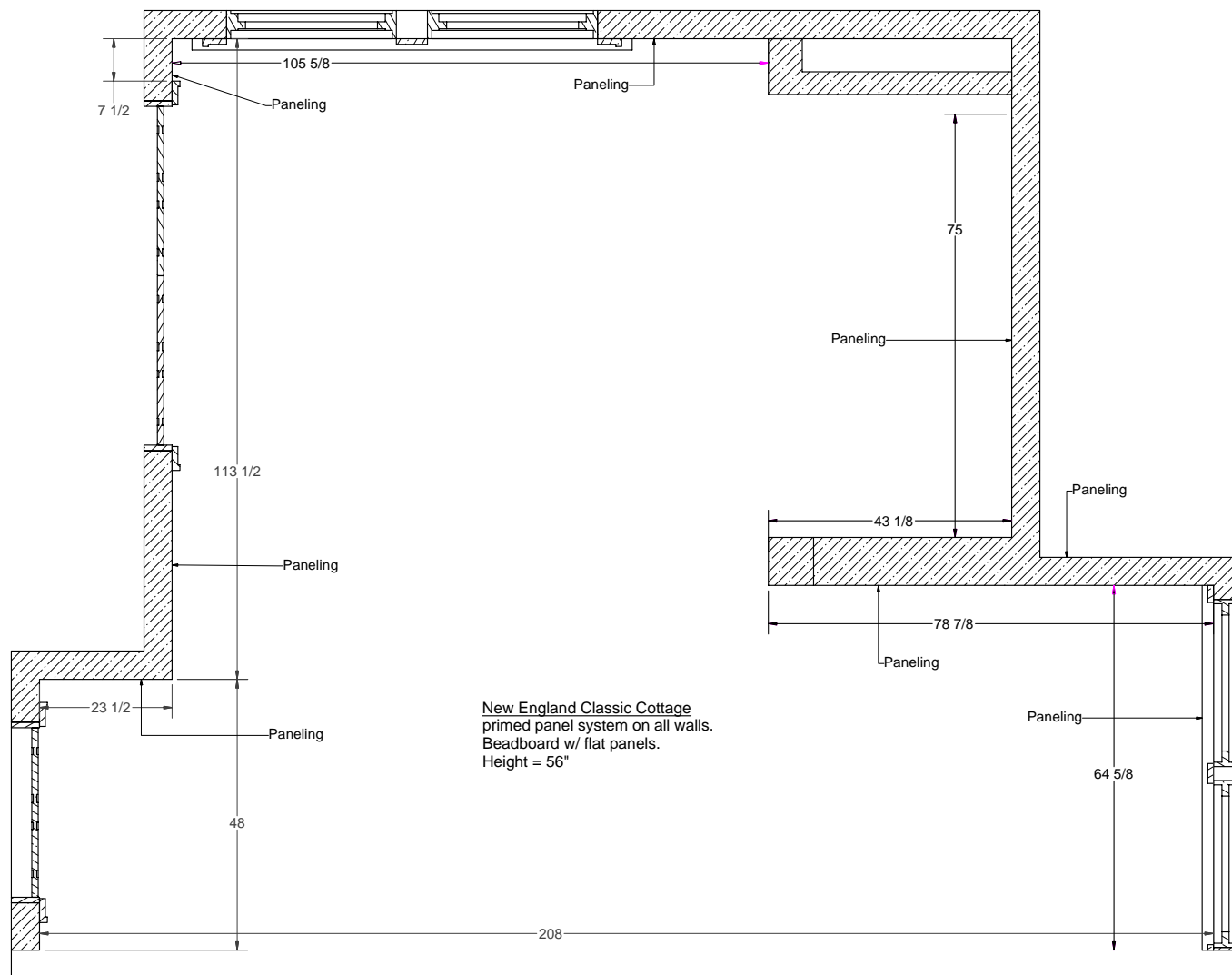

**FLOOR PLAN**



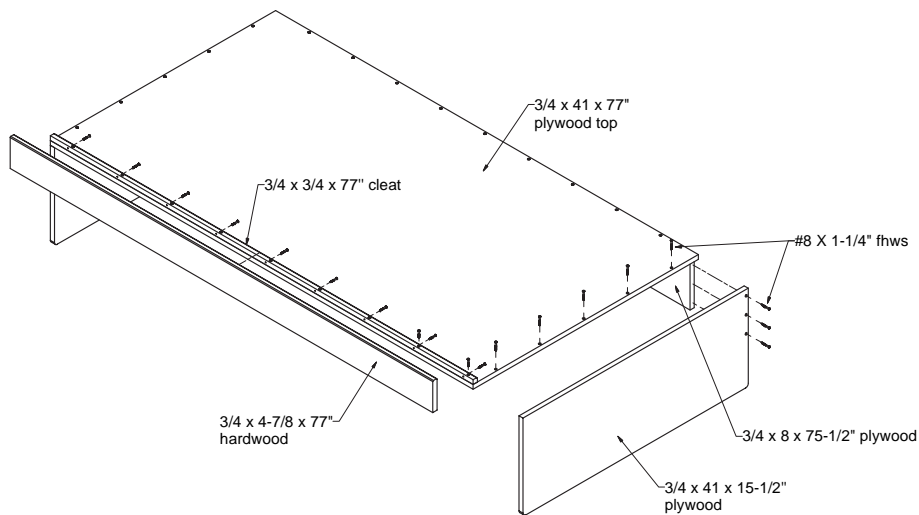

**Stationary Bed Box**

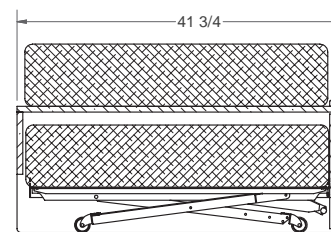

**SECTION VIEW  
(Bed & Trundle)**

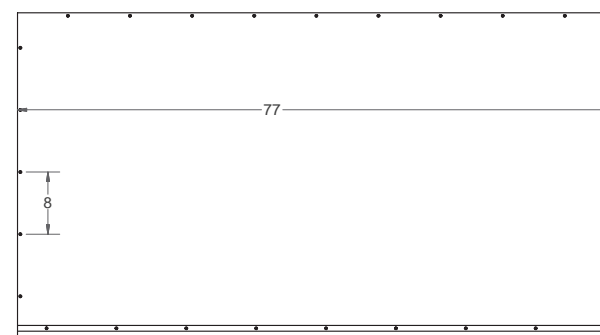

**TOP VIEW**

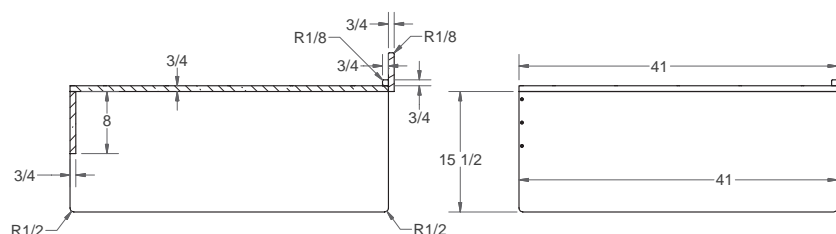

**SECTION A-A**

**SIDE VIEW**

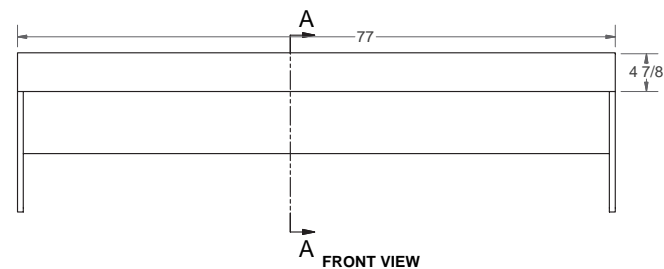

**FRONT VIEW**

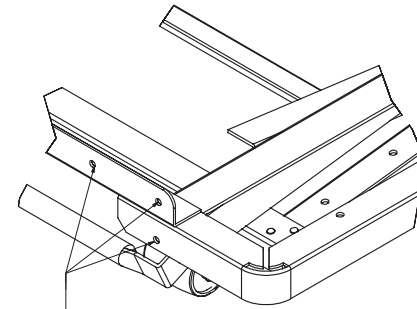
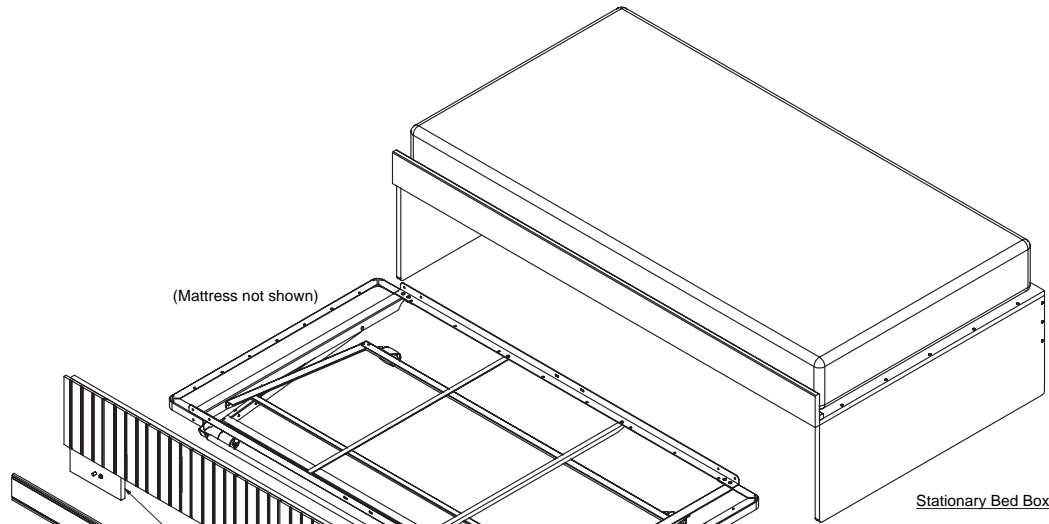

DETAIL A

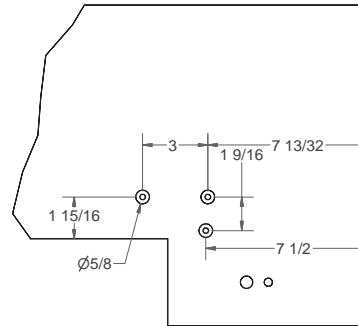
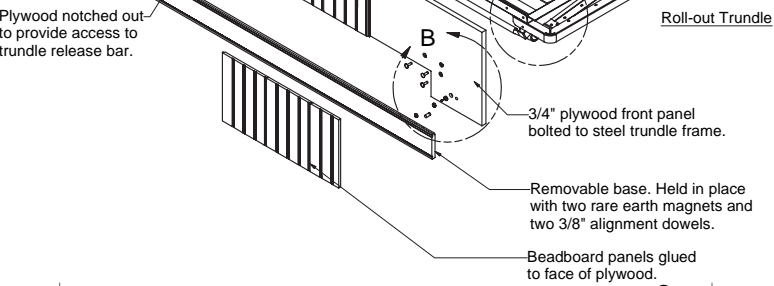

SCALE 0.35 : 1

Magnet strike plate

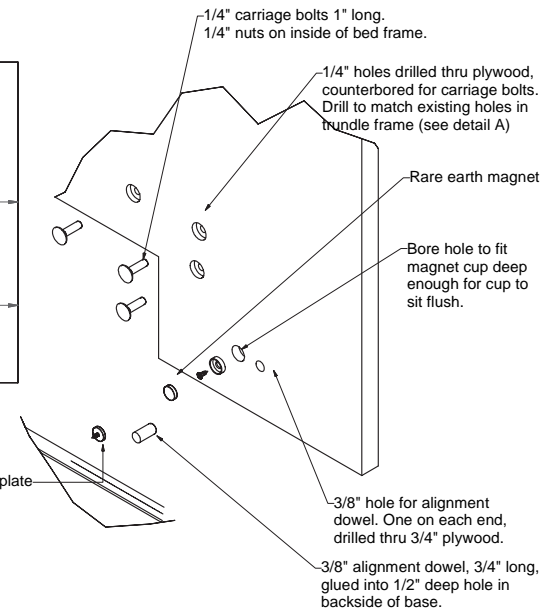

DETAIL B

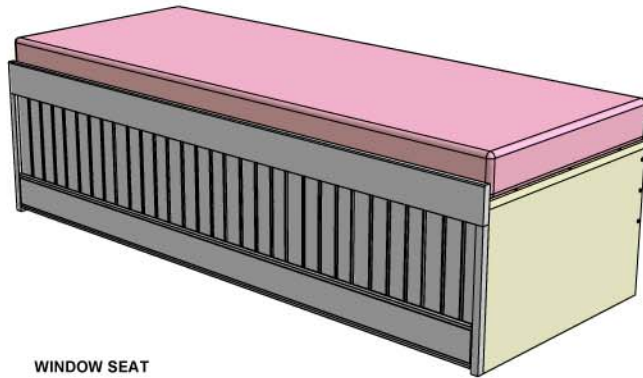

WINDOW SEAT

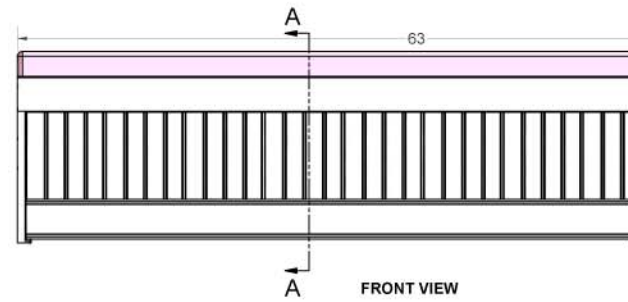

FRONT VIEW

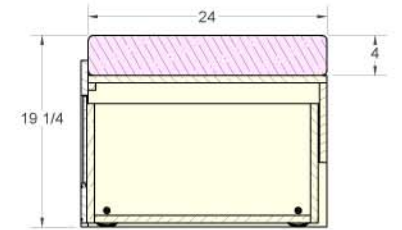

SECTION A-A

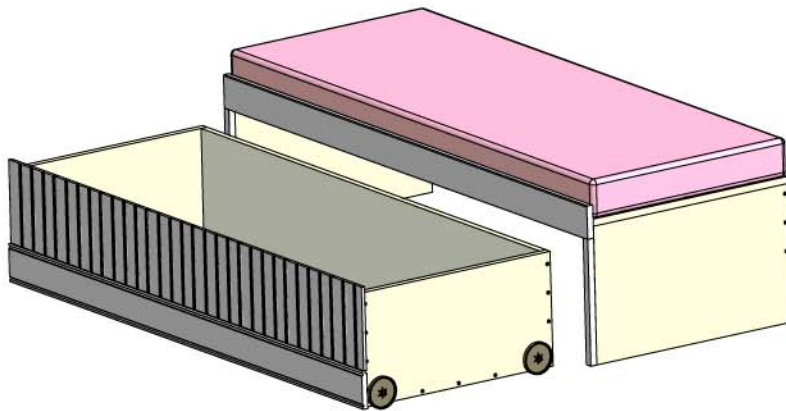

WINDOW SEAT  
w/ storage unit rolled out

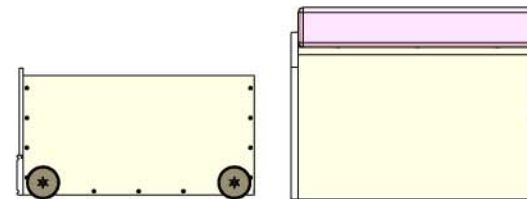

SIDE VIEW

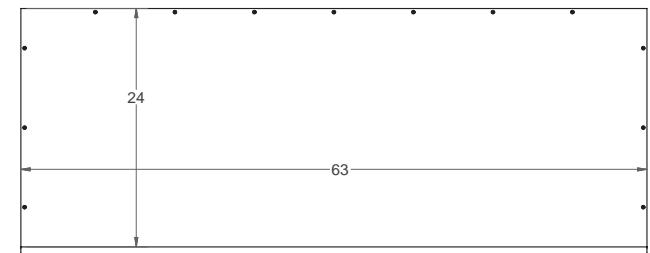
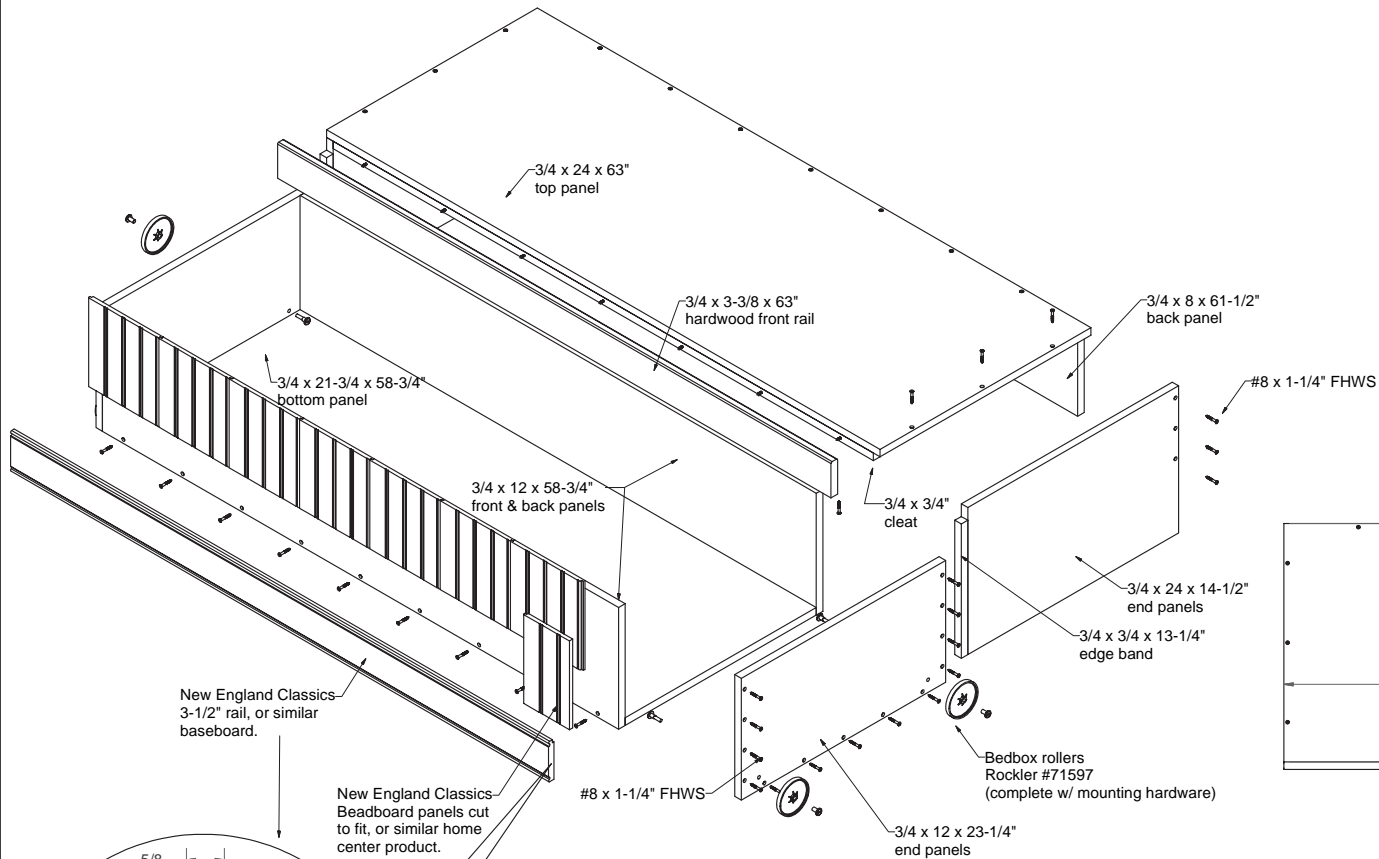

TOP VIEW

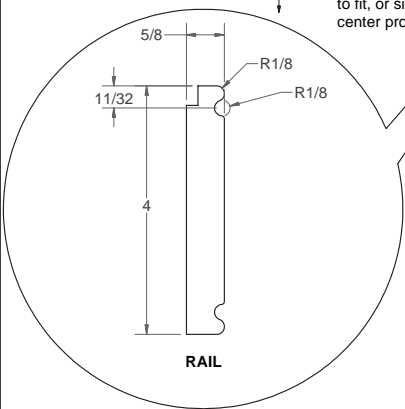

RAIL

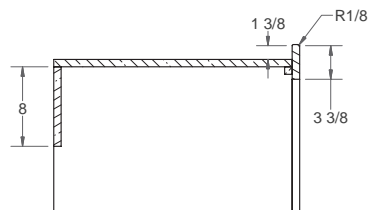

SECTION A-A

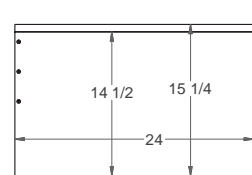

SIDE VIEW

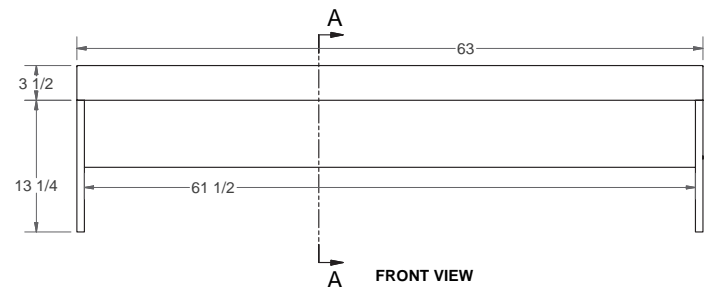

FRONT VIEW

