



Thank You!

You have successfully downloaded your document from Workbenchmagazine.com. Below are some tips for Trouble-Free Printing

- 1)** Clear printer memory. If you are unable to print this document, turn off your printer for at least 15 seconds and try again.

- 2)** Print two or three pages at a time. If clearing the printer memory didn't help, try printing only two or three pages at one time, rather than sending the entire file

- 3)** If a document is required to be at an accurate scale set the page scaling option to "none" in your printer settings.

- 4)** Get advanced printer help. Visit Adobe Support for instructions in troubleshooting common printer problems.

<http://www.adobe.com/support/techdocs/316508.html>

MATERIALS LIST

A (2) Headboard Legs	3 x 3 -48	F (12) Headboard Slats	5/8 x 4 3/4 -11 1/8	K (4) Balls	4" Round
B (2) Footboard Legs	3 x 3 -32	G (12) Footboard Slats	5/8 x 4 7/8 -12 3/8	L (2) Side Rails	1 x 6 -81 1/2
C (2) Top Rails	1 x 8 -78 1/4	H (1) Hdbrd. Starter Slat	5/8 x 5 1/8 -11 1/8	M (4) Ogee Blocks	1 x 3 -12
D (2) Bottom Rails	1 x 6 -78 1/4	I (1) Ftbrd. Starter Slat	5/8 x 5 1/8 -12 3/8	N (2) Side Rail Cleats	1 x 1 -81 1/2
E (1) Stretcher	1 x 6 -78 1/4	J (4) Capitals	1 x 4 -4	O (2) Hdbrd./Ftbrd. Cleats	1 x 1/4 1 -75

CUTTING DIAGRAM

8/4 x 7 1/4 - 96" CHERRY (TWO BOARDS)

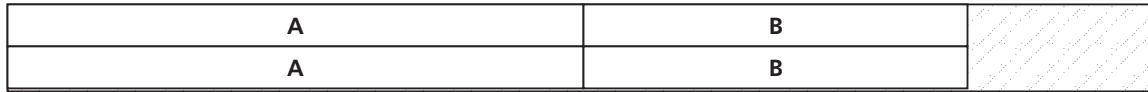

5/4 x 5 1/2 - 84" CHERRY (FOUR BOARDS)



5/4 x 7 1/4 - 96" CHERRY (TWO BOARDS)

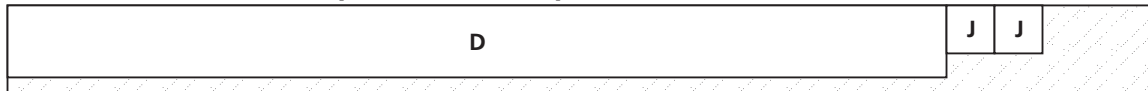

5/4 x 7 1/4 - 84" CHERRY



4/4 x 5 1/2 - 96" CHERRY (TWO BOARDS)

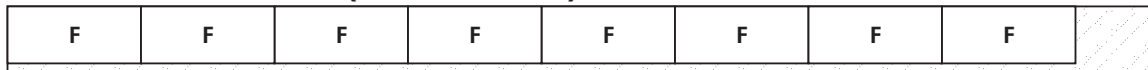

4/4 x 5 1/2 - 96" CHERRY (TWO BOARDS)

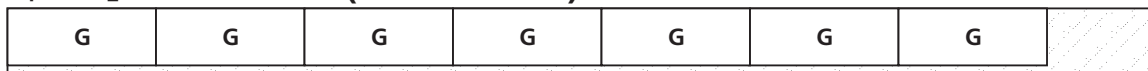

4/4 x 5 1/2 - 60" CHERRY



5/4 x 7 1/4 - 96" CHERRY (TWO BOARDS)

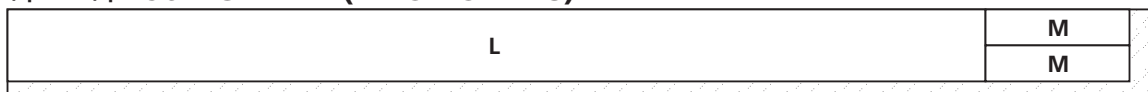

5/4 x 5 1/2 - 84" MAPLE

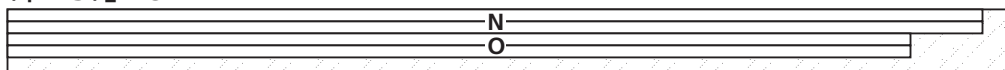

CUTTING DIAGRAM

3/4" x 48" - 96" FIR PLYWOOD (TWO SHEETS)

